

**CIAR 2100:  
PROJECT  
SIX**

**CADI  
KEPNER**

**COFFEE KIOSK**

**FINAL**

**MODEL**

**3/8" = 1'0"**

**SCALE**

FINAL MODEL

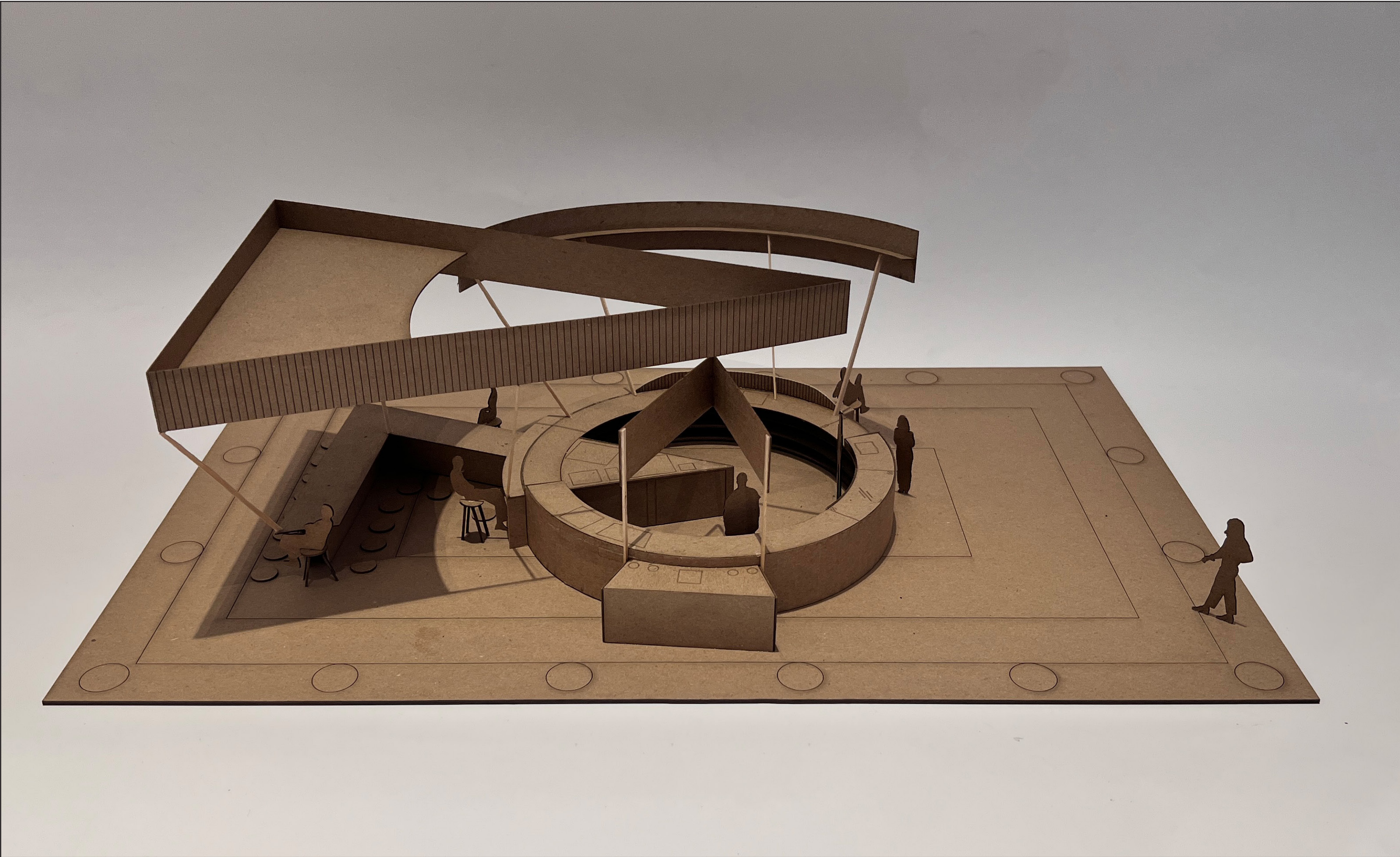

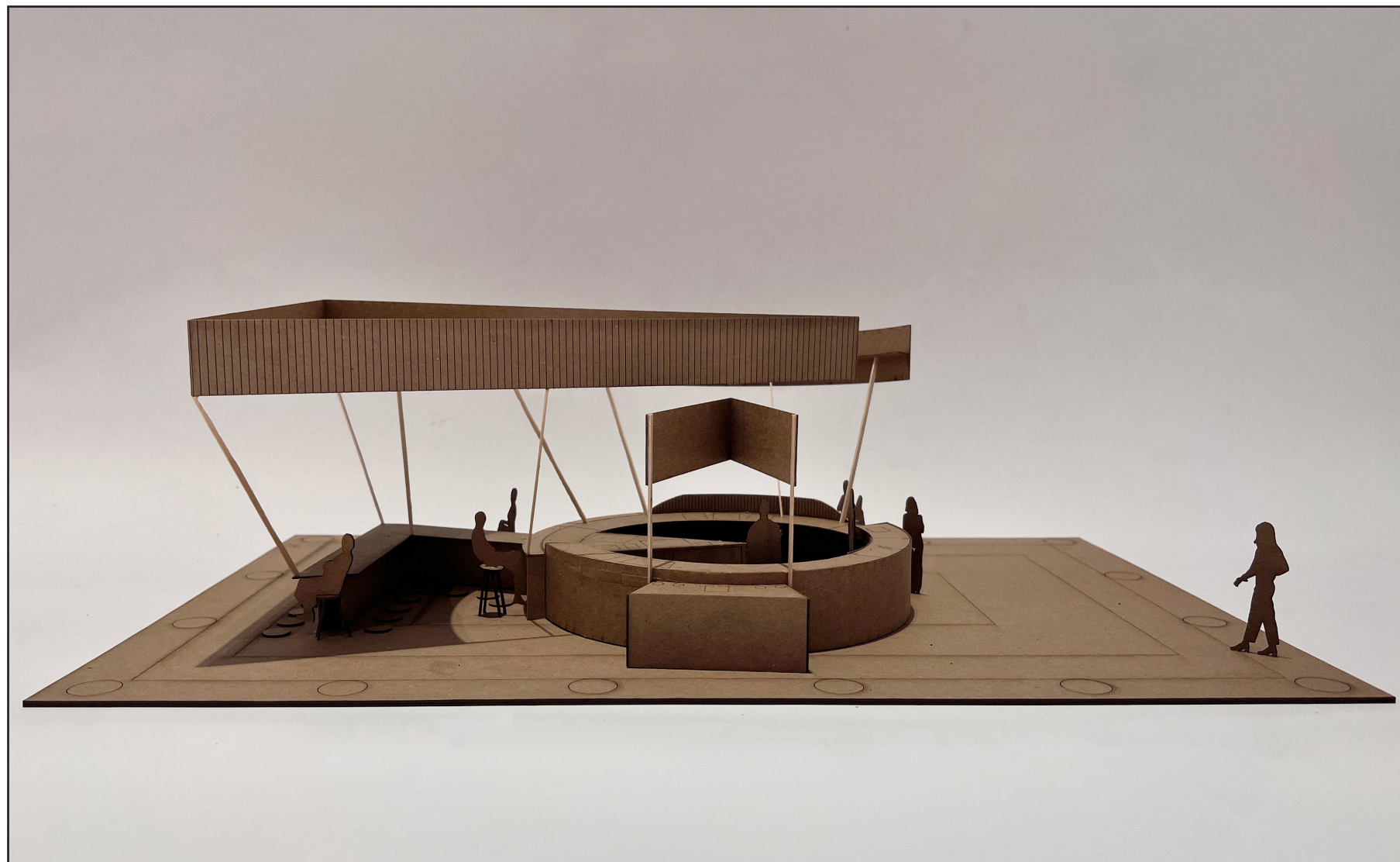

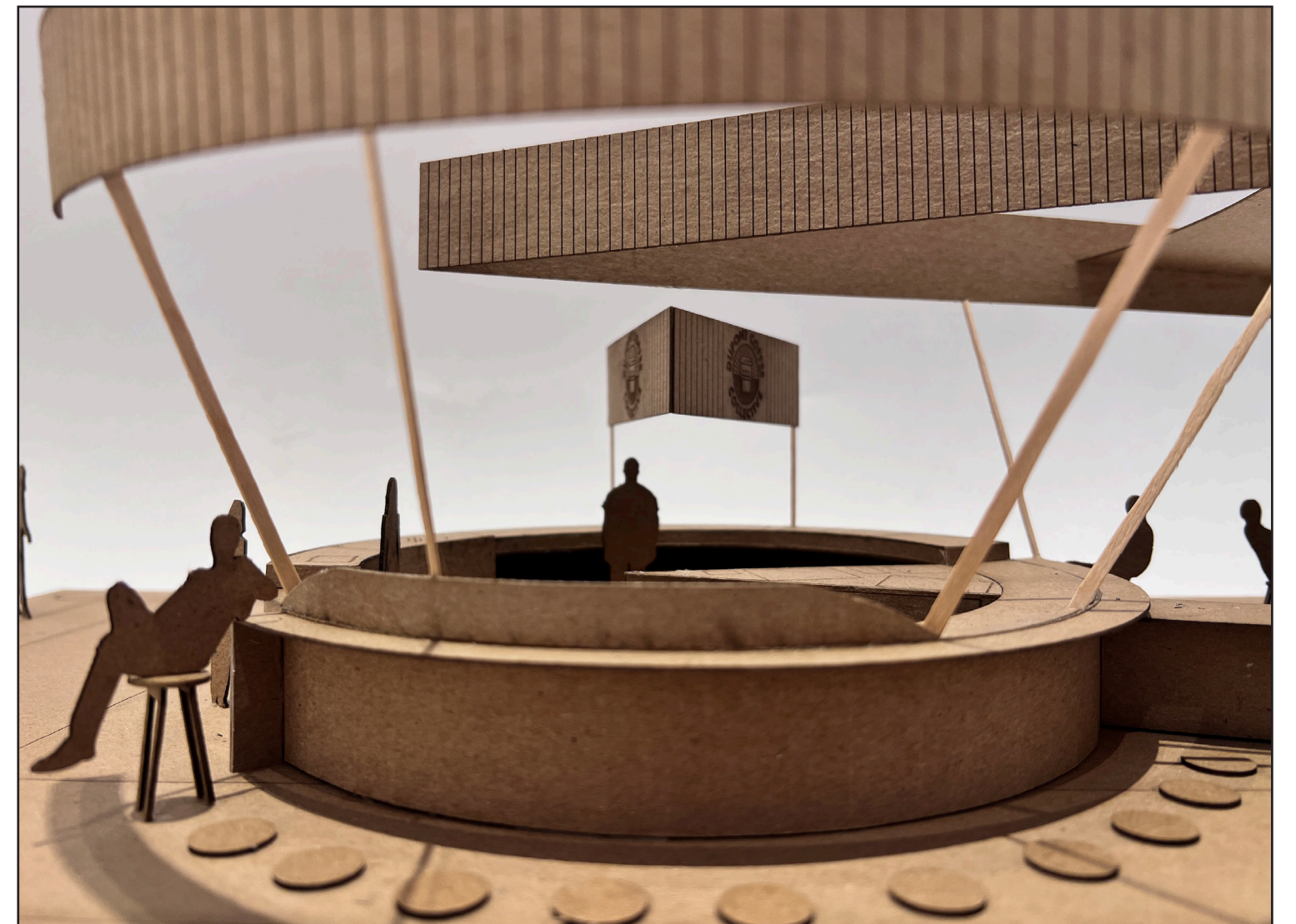
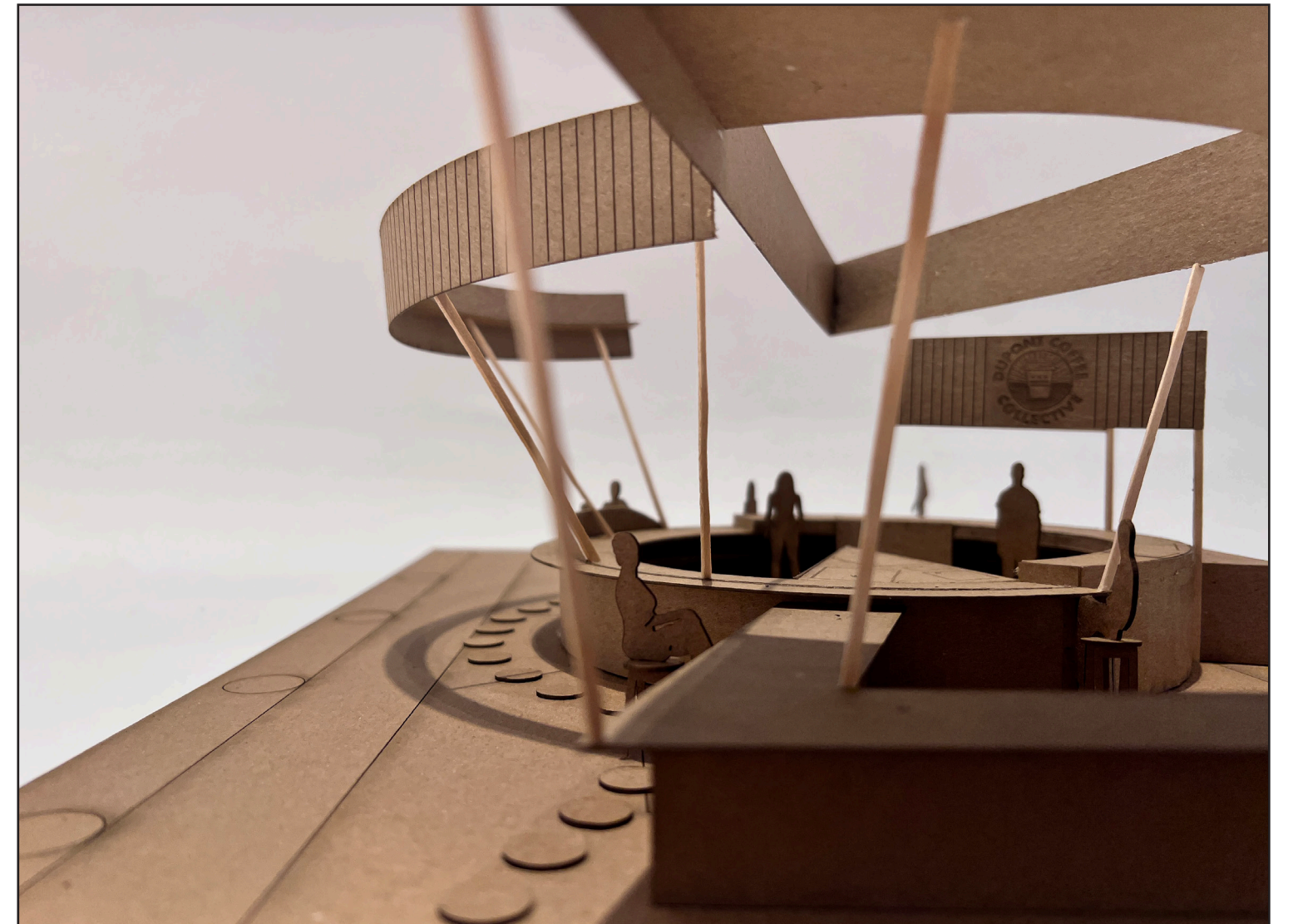
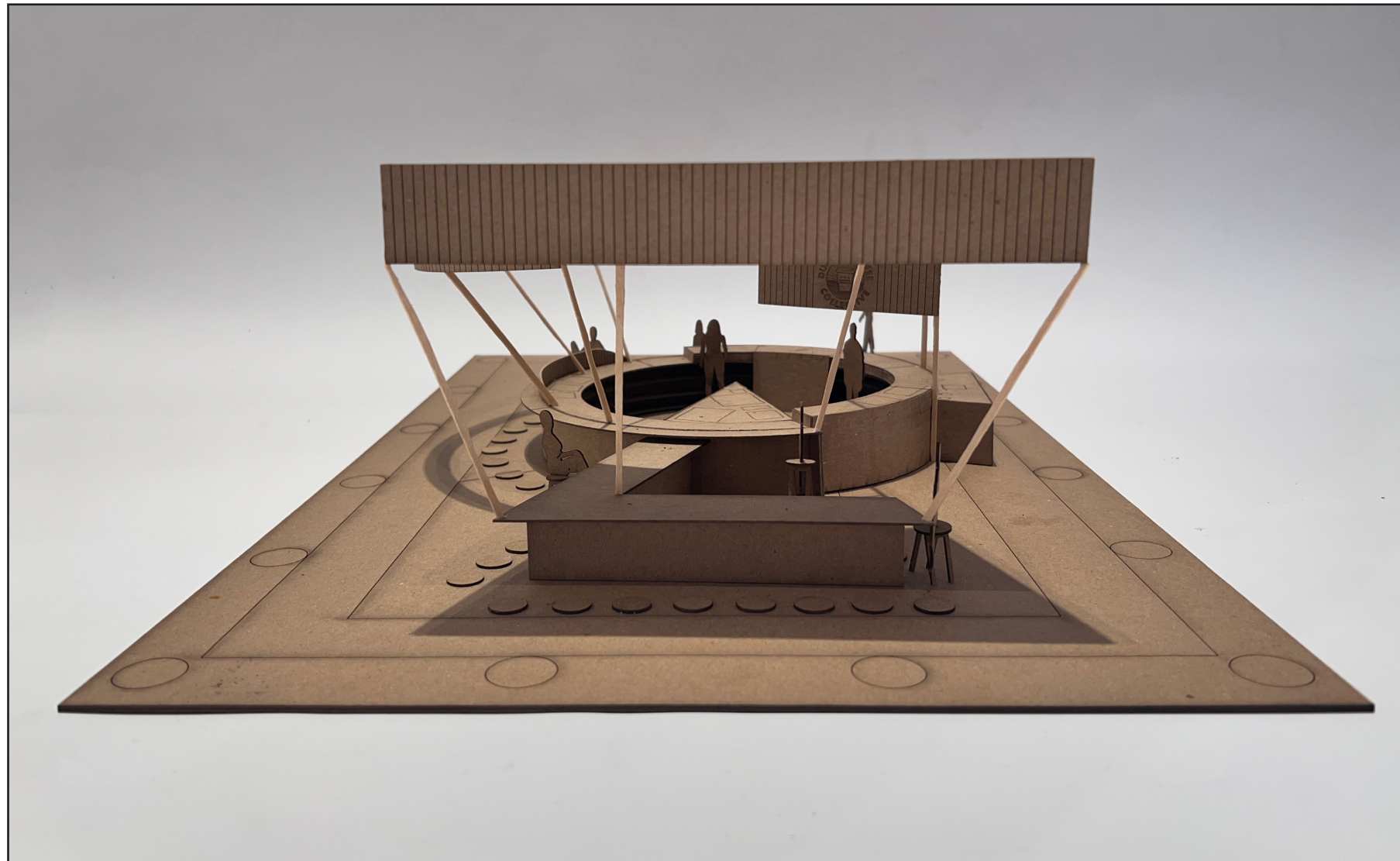

# FINAL FLOOR PLAN

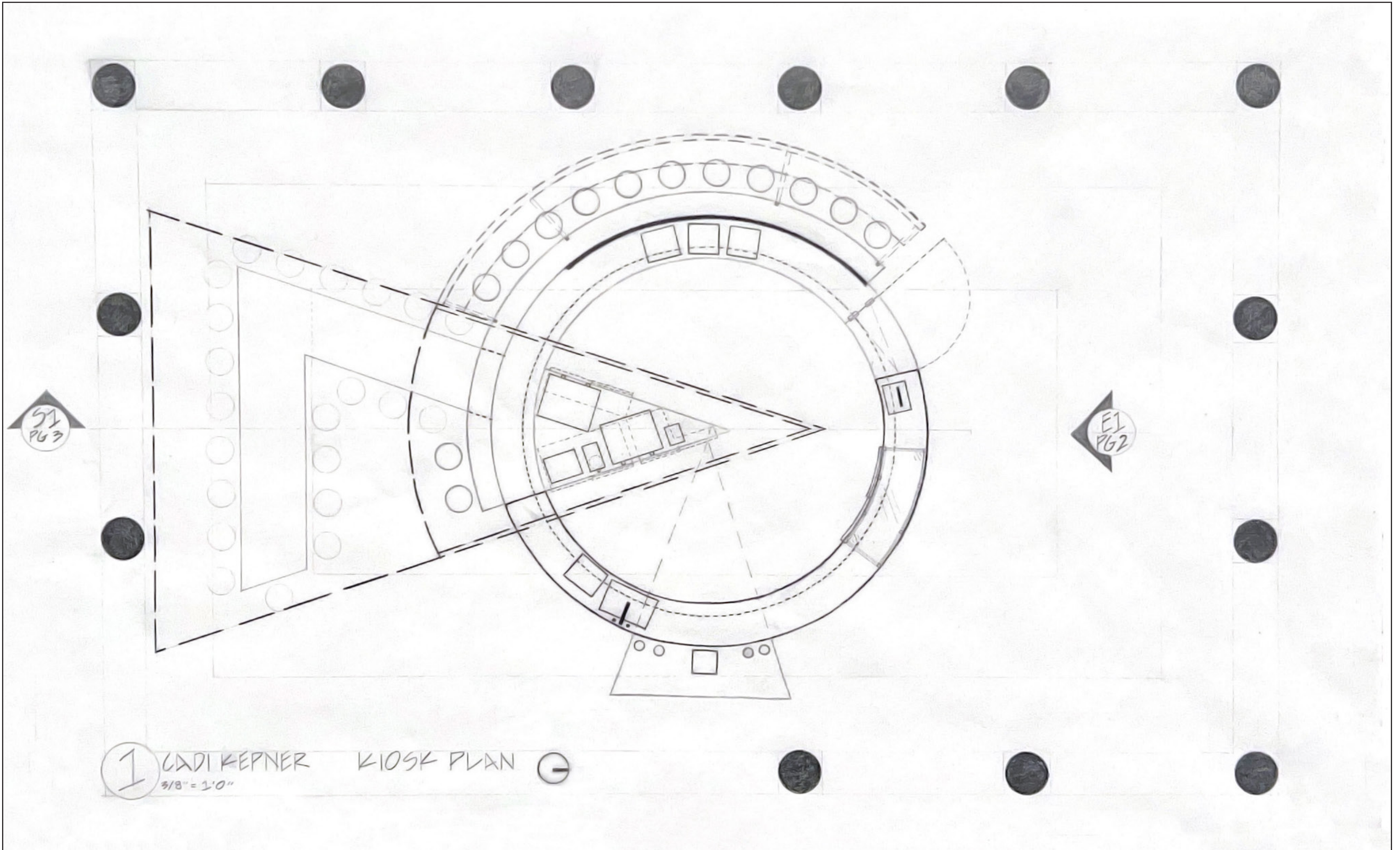

# FINAL ELEVATION

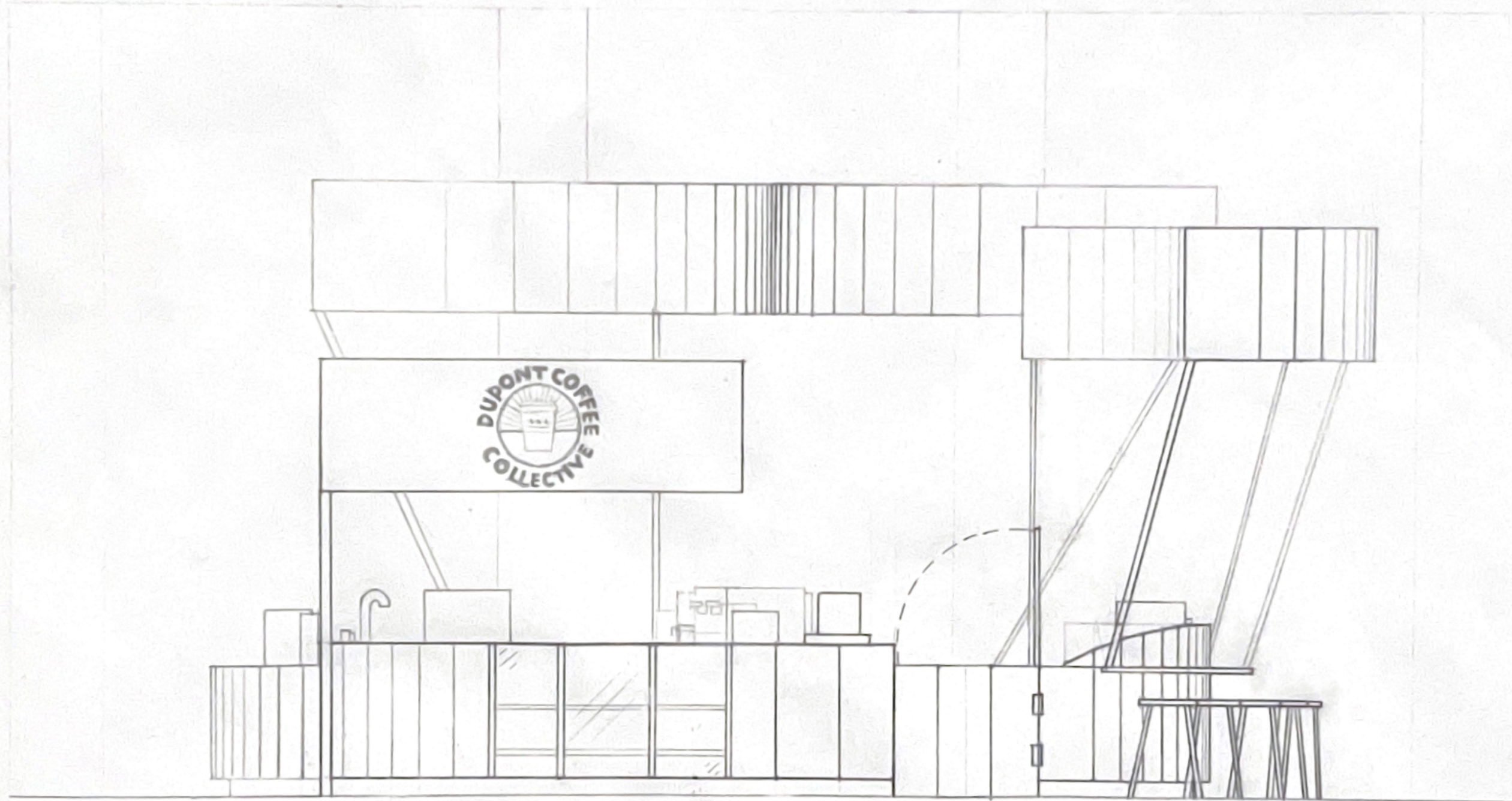

2 LADI KEPNER  
3/8" = 1'0"

KIOSK ELEVATION

# FINAL SECTION

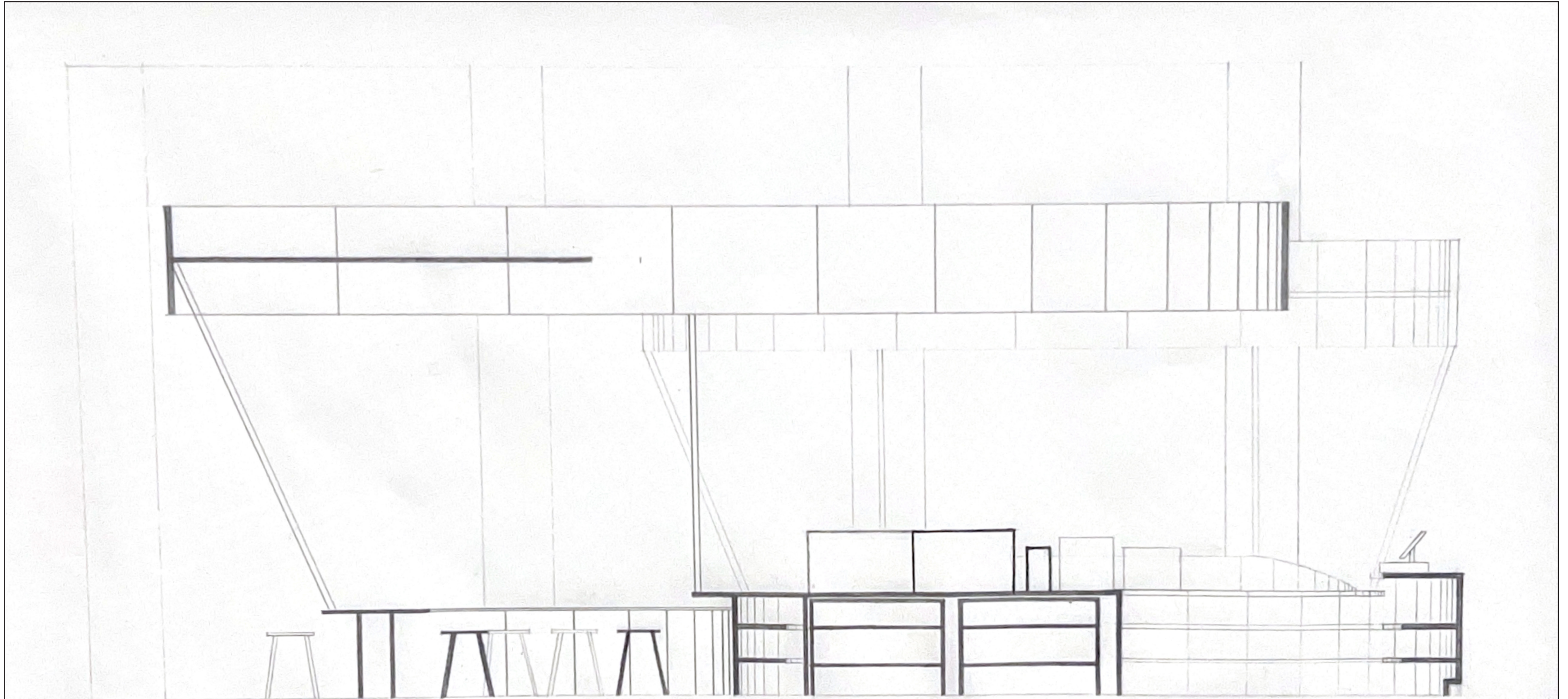

3 CADI KEPNER  
3/8" = 1'0"

KIOSK SECTION

**CONCEPT  
PHASE**

## EXPANSIVE RESURGENCE PART I

Beginning the process of creating a thoughtfully designed coffee kiosk for our fellow peers at The Corcoran Design School of the Arts at GW, there first needed to be a driving force of an ethos. Finding the coffee brand with the same perspective as all those who will frequent the coffee kiosk was an important factor in creating the design that Corcoran and its students deserve. Discovering Dupont Coffee Collective created a forward motion in the project process with their brand emphasis on serving those who support them, as they are an employee-owned company, they care about those around them. This coffee brand also donates heavily to local community-based organizations, furthering their devotion to loyal customers and communities. From this harmonious idea of devotion to those around us spurred the focus this project has on serving, supporting, and boasting the amazing students, faculty, and alumni that The Corcoran has frequent it's halls every day. Furthering this attention to those that make up The Corcoran presently and in the past is the driving quote of "Dedication to Art," which The Corcoran boasts as its motto. In addition to this important historical quote, is the amazing history of radical and free art that The Corcoran has exhibited, whether from artists living in DC, it's students, or any artists that created thought-provoking art. But through research of the history of The Corcoran, there has been a significant decline in a focus on radical art, especially the exhibitions of radical art from our community. Articles tell stories of art plastered on every wall, and furious artists who once worked diligently in these halls fill the long history of The Corcoran. That is why this project, first and foremost, focuses on the resurgence of what once was, "Dedication to Art," and those who make it. This project seeks to expand and resurge what once was. From these two words exploded numerous conceptual ideas of models and plans, spanning from conceptual process models of two shapes that expand on each other, to a partition that expands and bridges two shapes, but after finally combining ideas from process concept models was the idea of spatial growth to represent "expansive resurgence". From this came an idea of twisting from one smaller shape to a larger, more expansive shape in two forms, a triangle and a circle, which were chosen to represent a never-ending tale of growth, as both shapes have inviting borders that do not end at a ninety-degree angle hard edge but a flowing line of the circle or interest and invitation of continuing past the non concrete corner of the triangle. Finalizing this concept, then came the translation to floor plans, which came from two different two-dimensional pictures of the final conceptual model, creating a triangle and circle that have expanding ceiling planes to represent expansive resurgence. From these conceptual ideas of expansion and varying heights of ceiling planes, and the reflective variation in counter heights to signify expansion and growth from every point, whether at a bird's eye view of plans, or the real perspective of everyday use. The ceiling planes also represent more than just the concept, but also the ethos of "Dedication to Art," as each upper plane will exhibit and rotate artists' work from The Corcoran, allowing the business, students, and faculty to support each other and boast the immense talent The Corcoran holds in its walls, additionally this amount of art displayed every day in the central point at which all walk through, the atrium, shows the resurgent nature of this project and its emphasis on recreating what The Corcoran once was, full of art. This project was a labor of love, presenting many problems to be solved, but it created a result worth calling dedicated to art.

FINAL CONCEPT MODEL



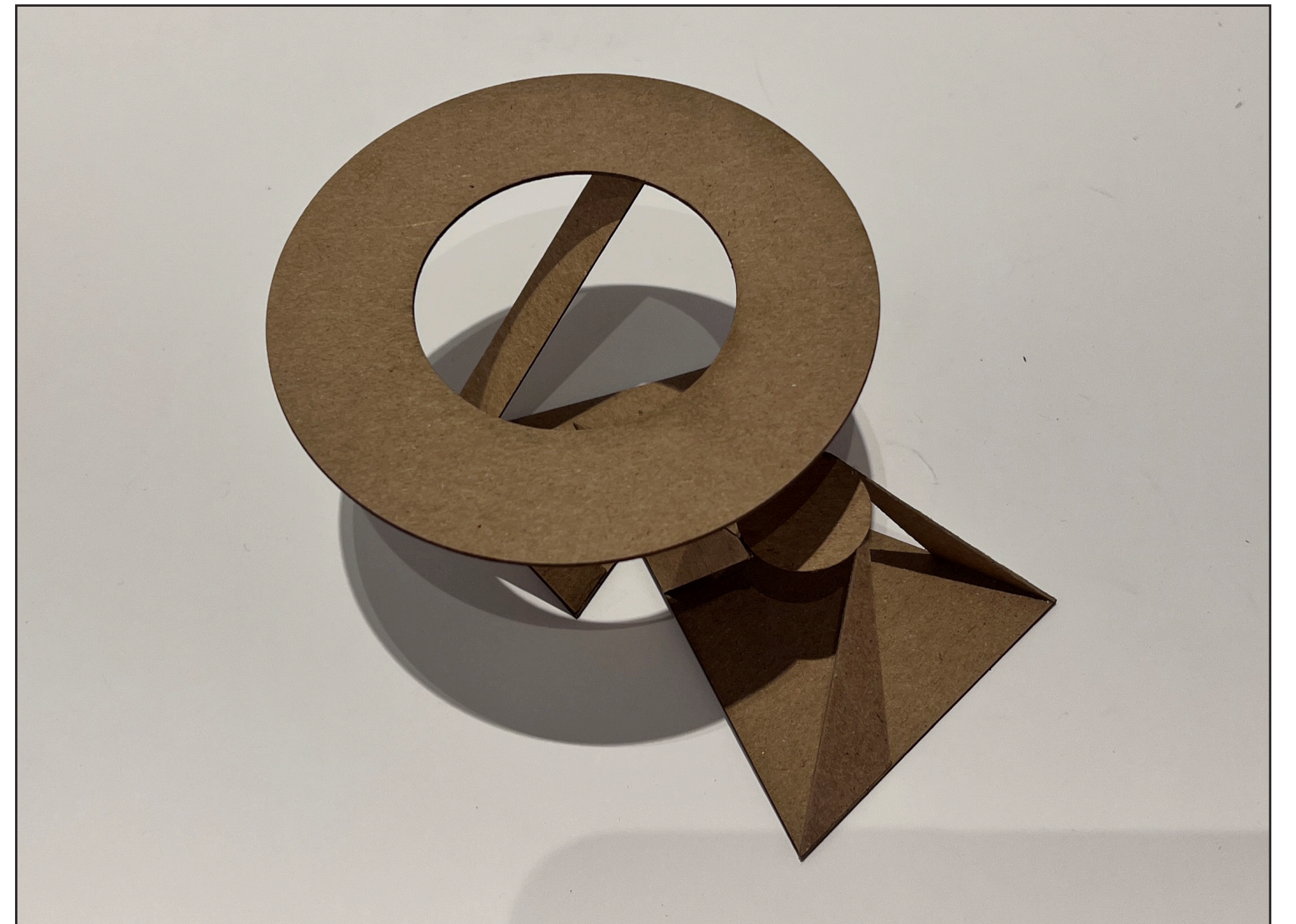
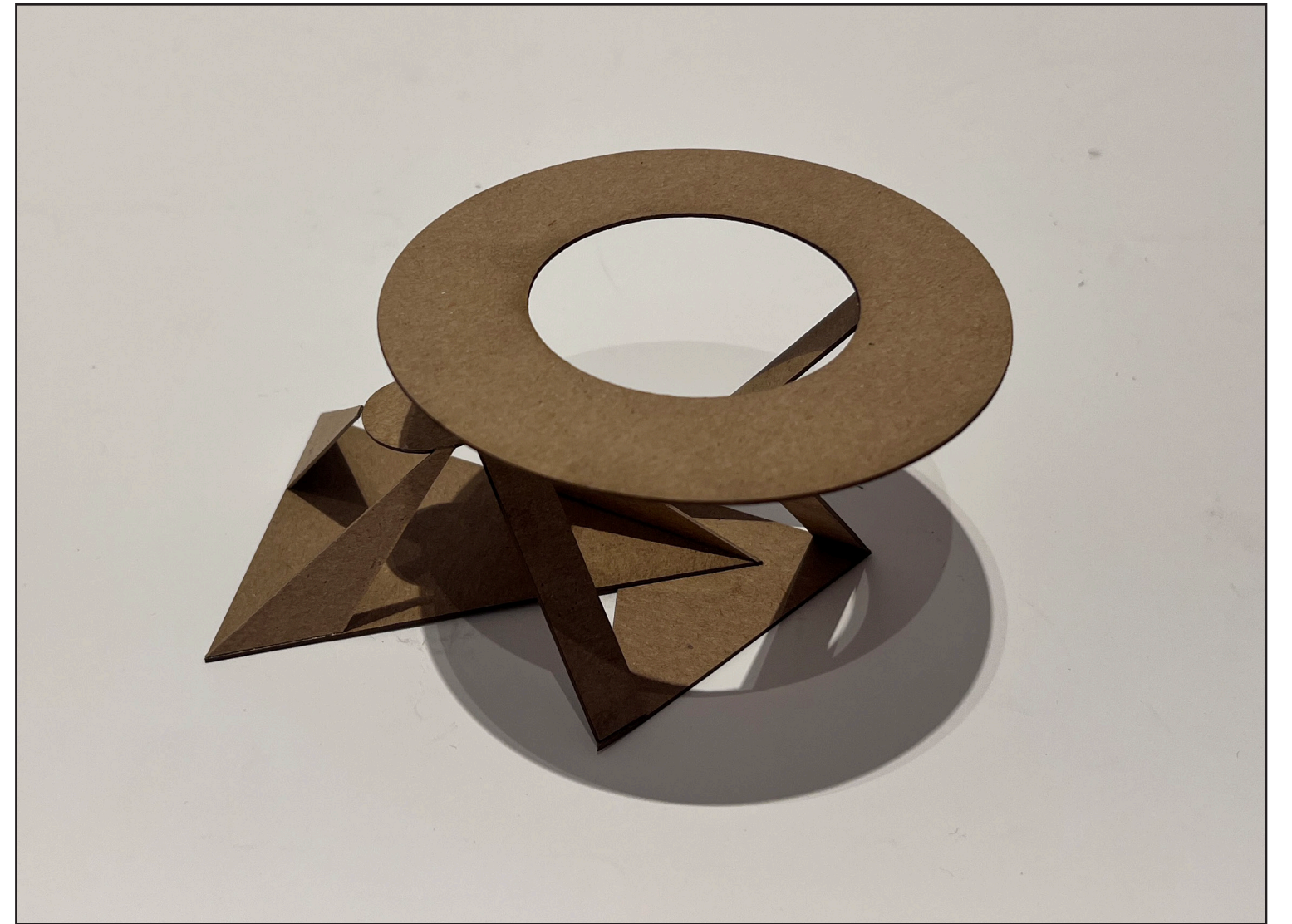

# FINAL CONCEPT DIAGRAM

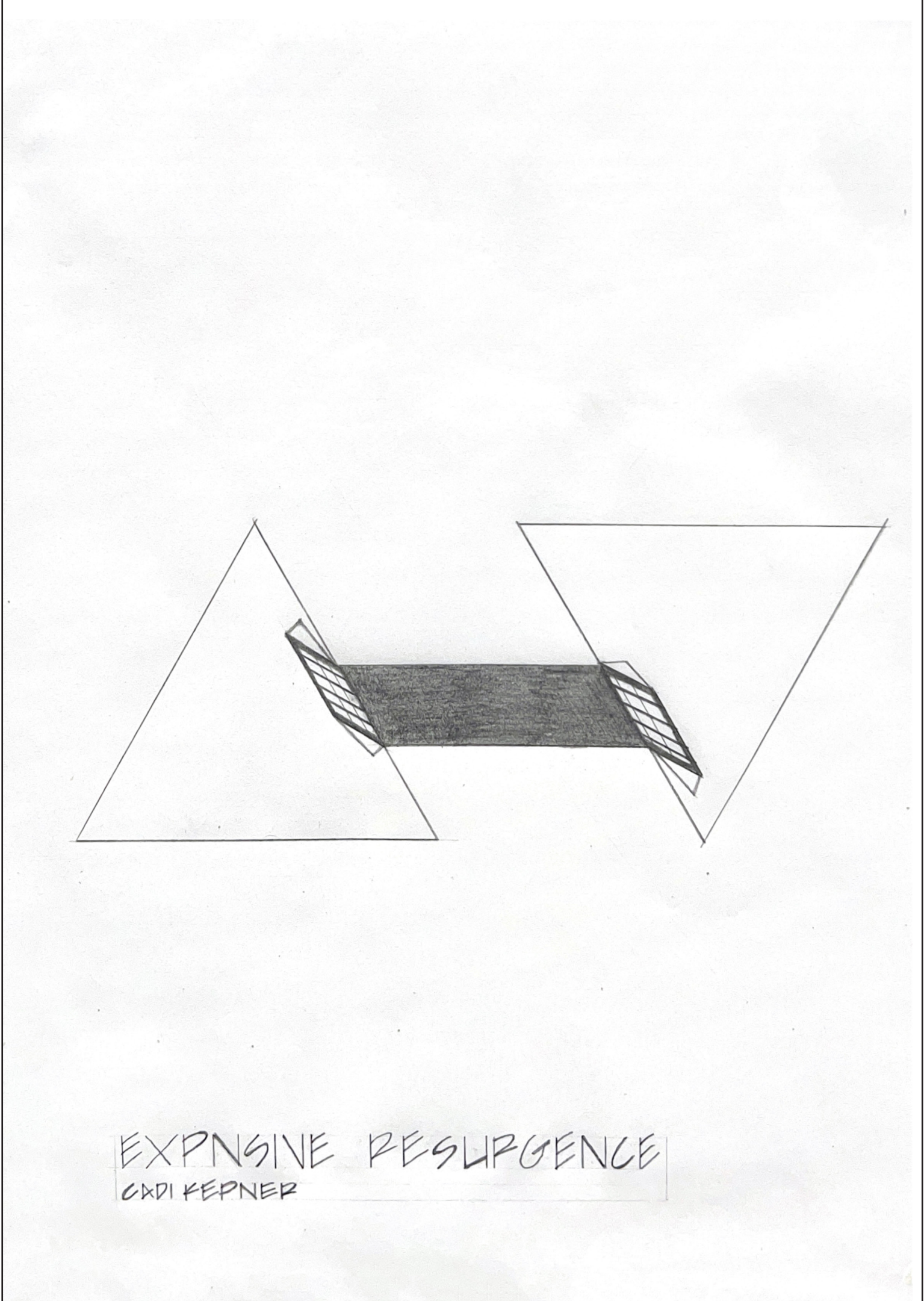

EXPENSIVE RESURGENCE  
CADI KEPNER

**PROCESS  
WORK**

# DRAFT PLAN

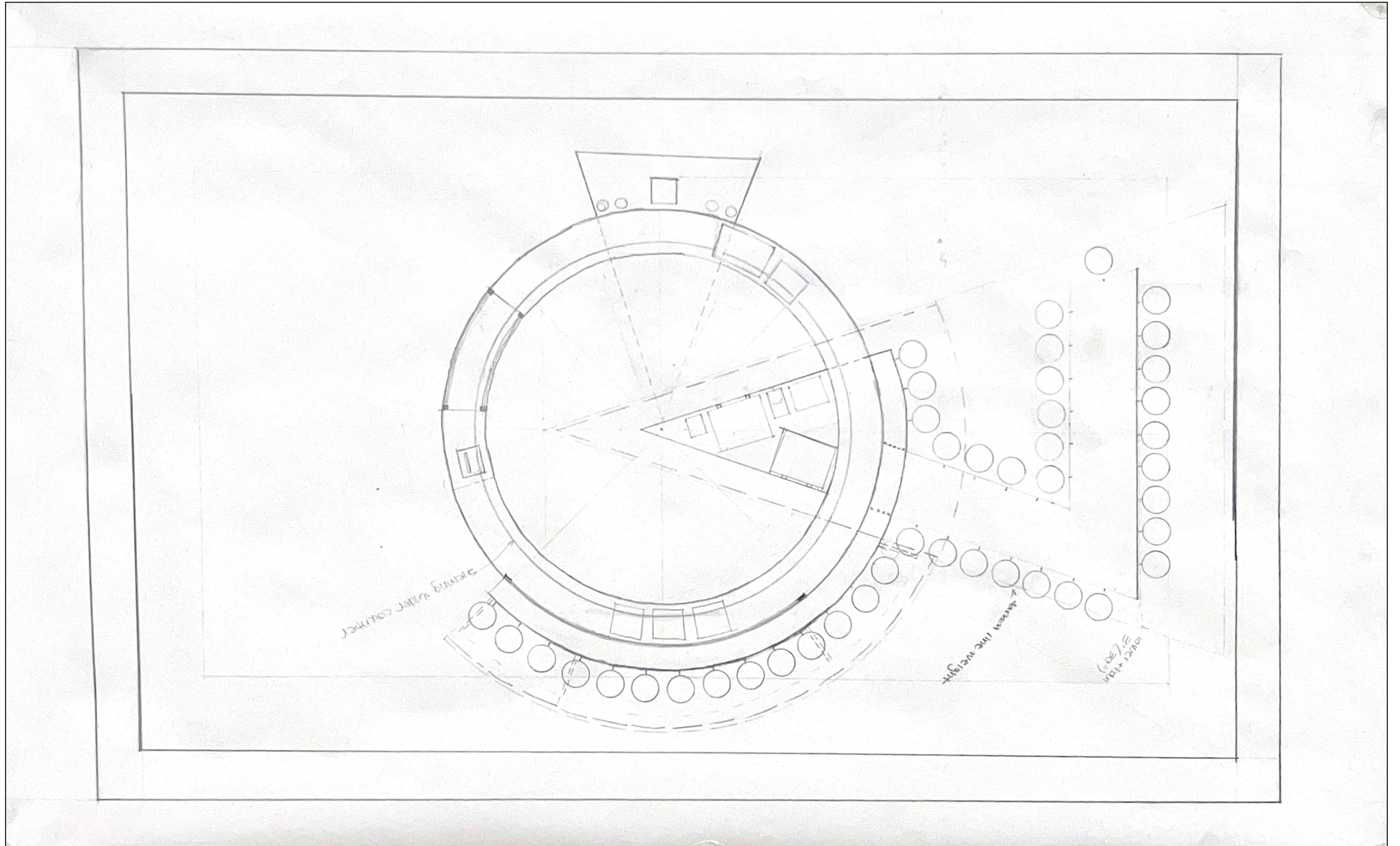

# FINAL STUDY MODEL

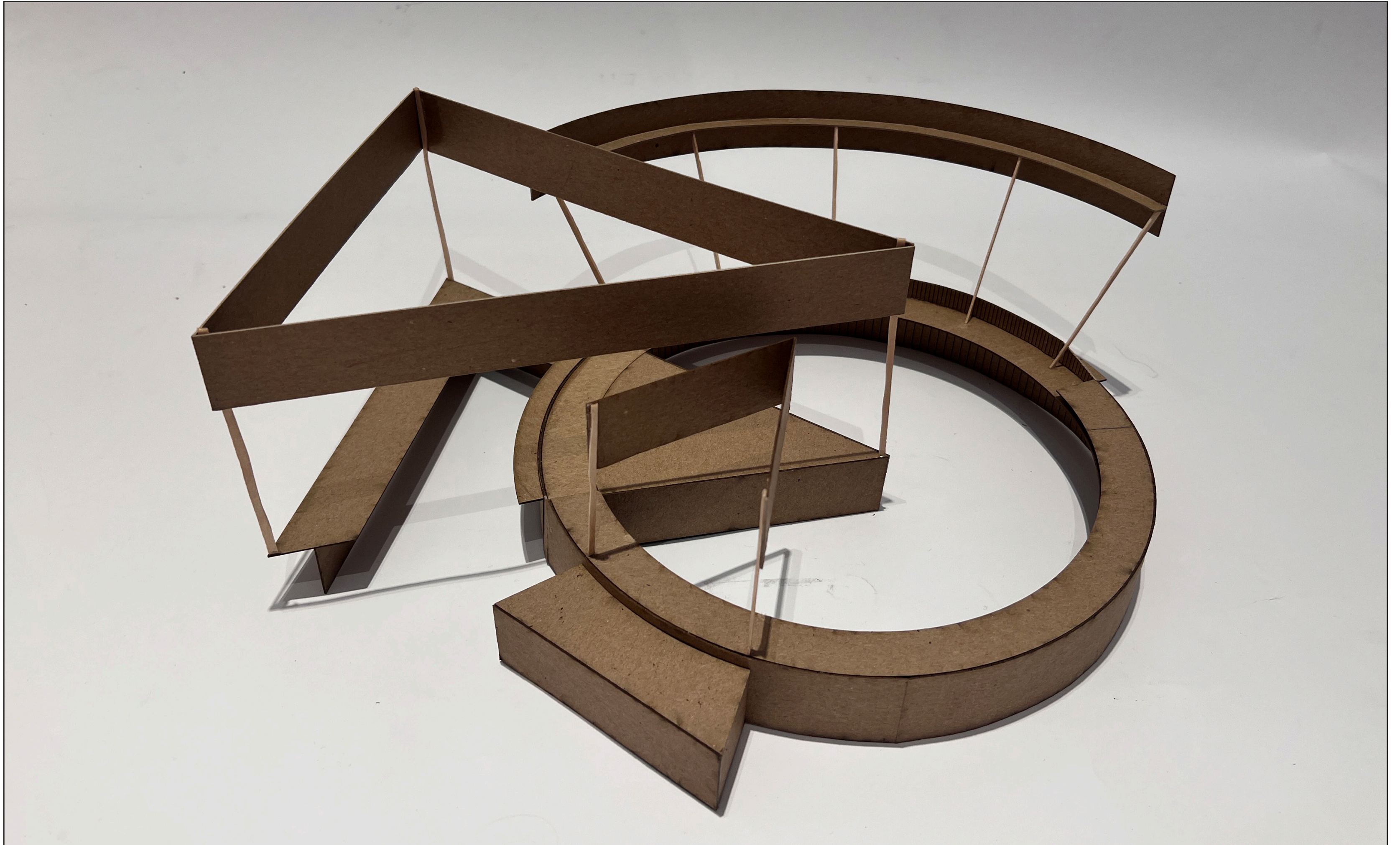

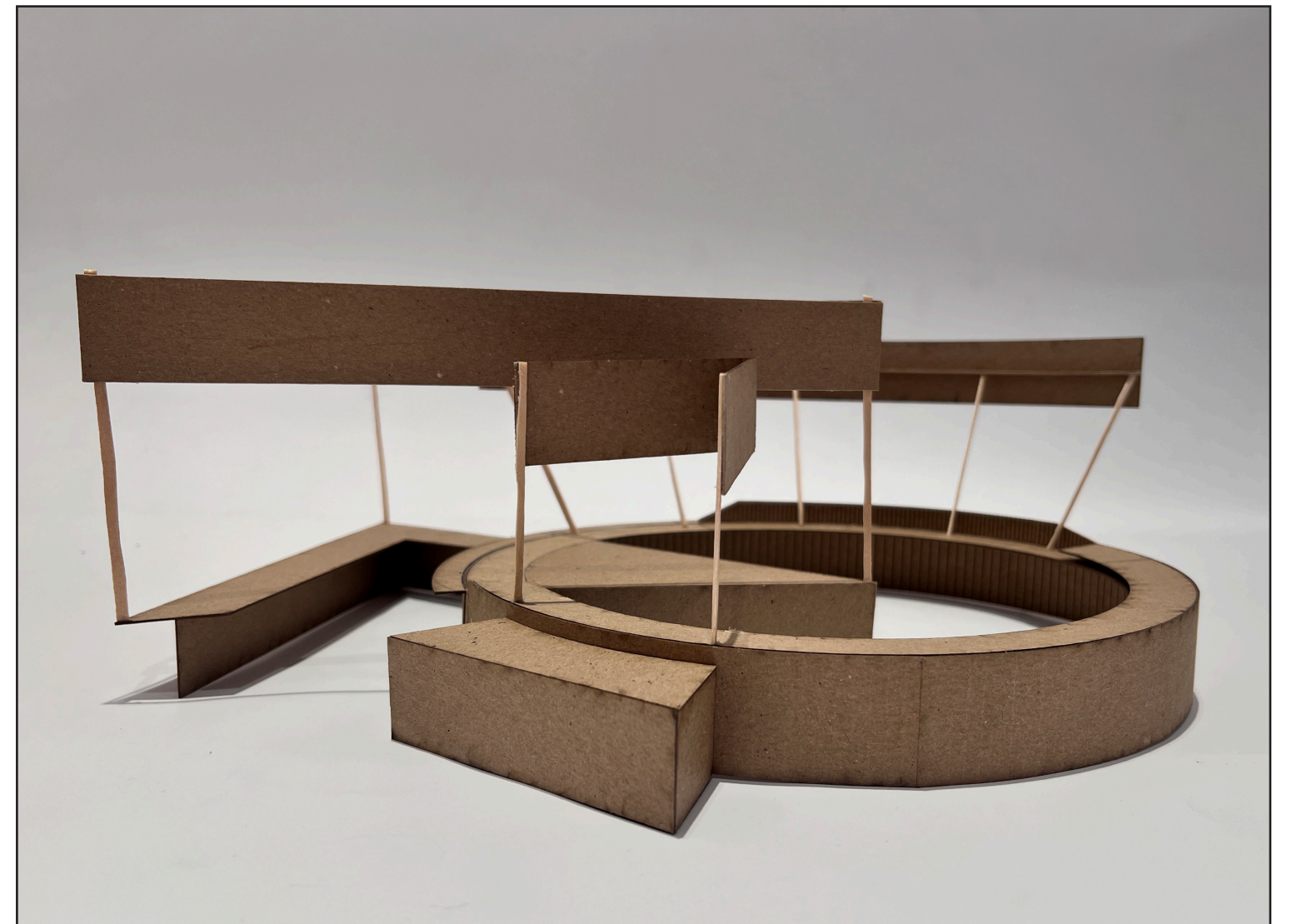
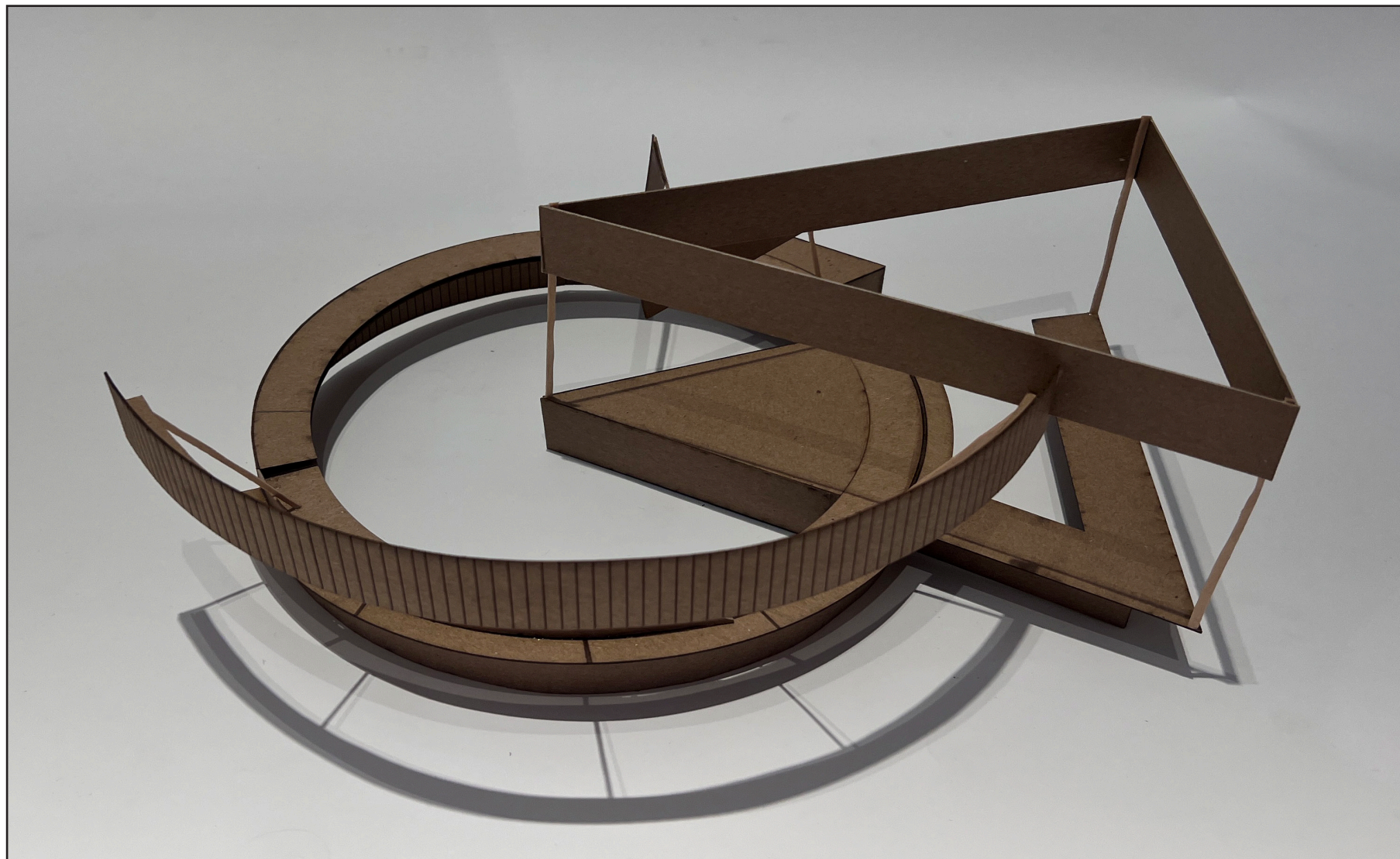
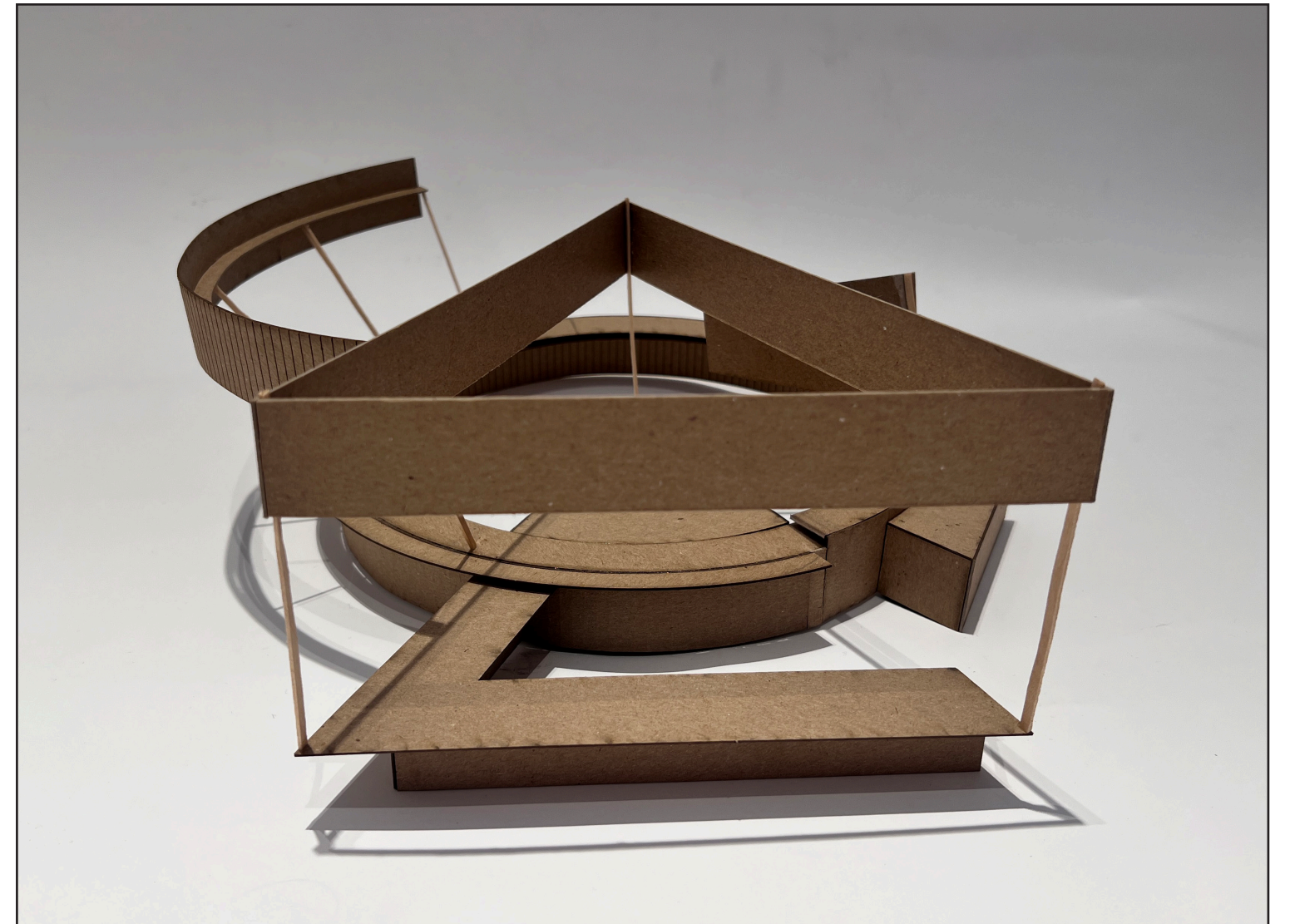
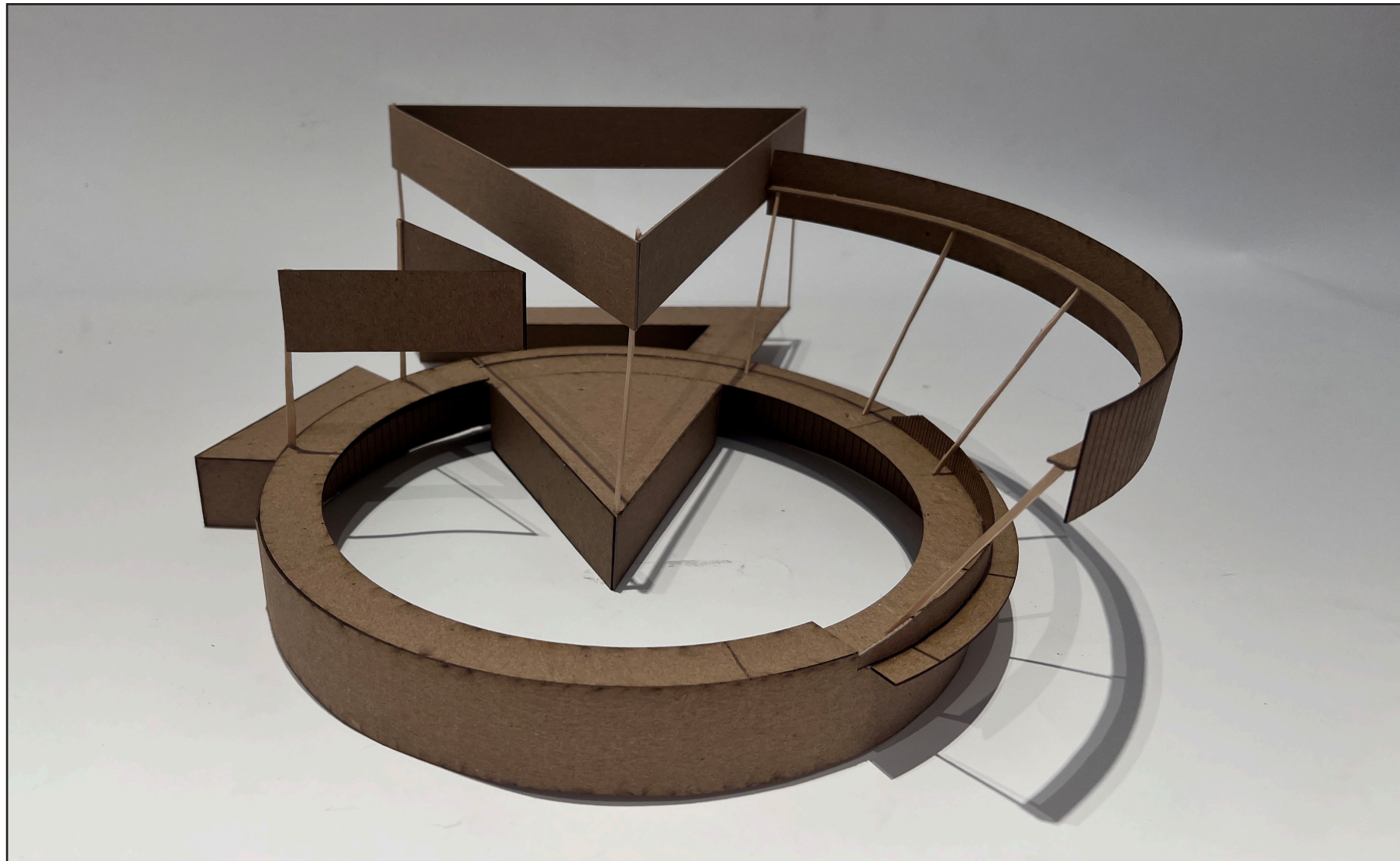

STUDY MODELS

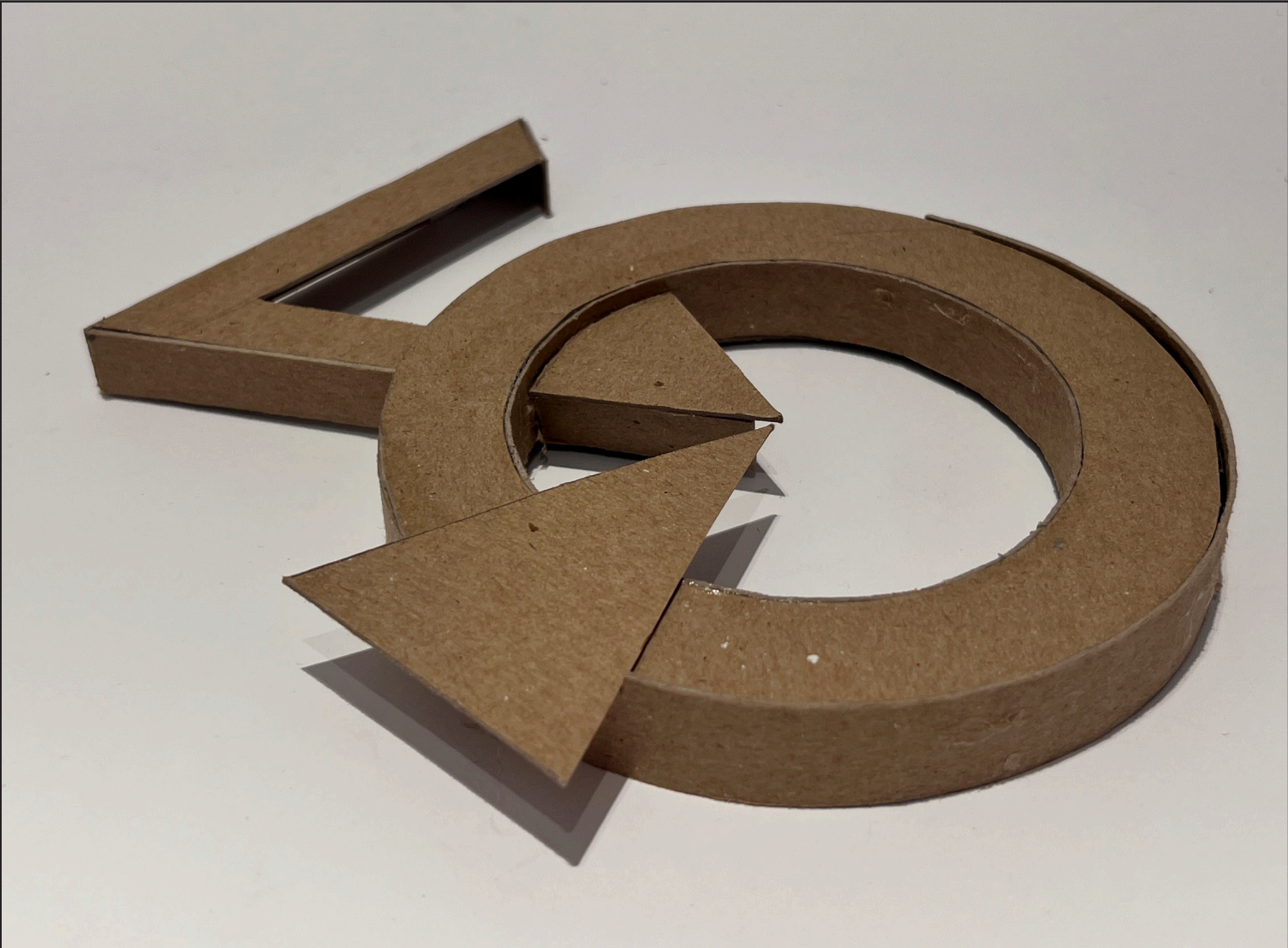
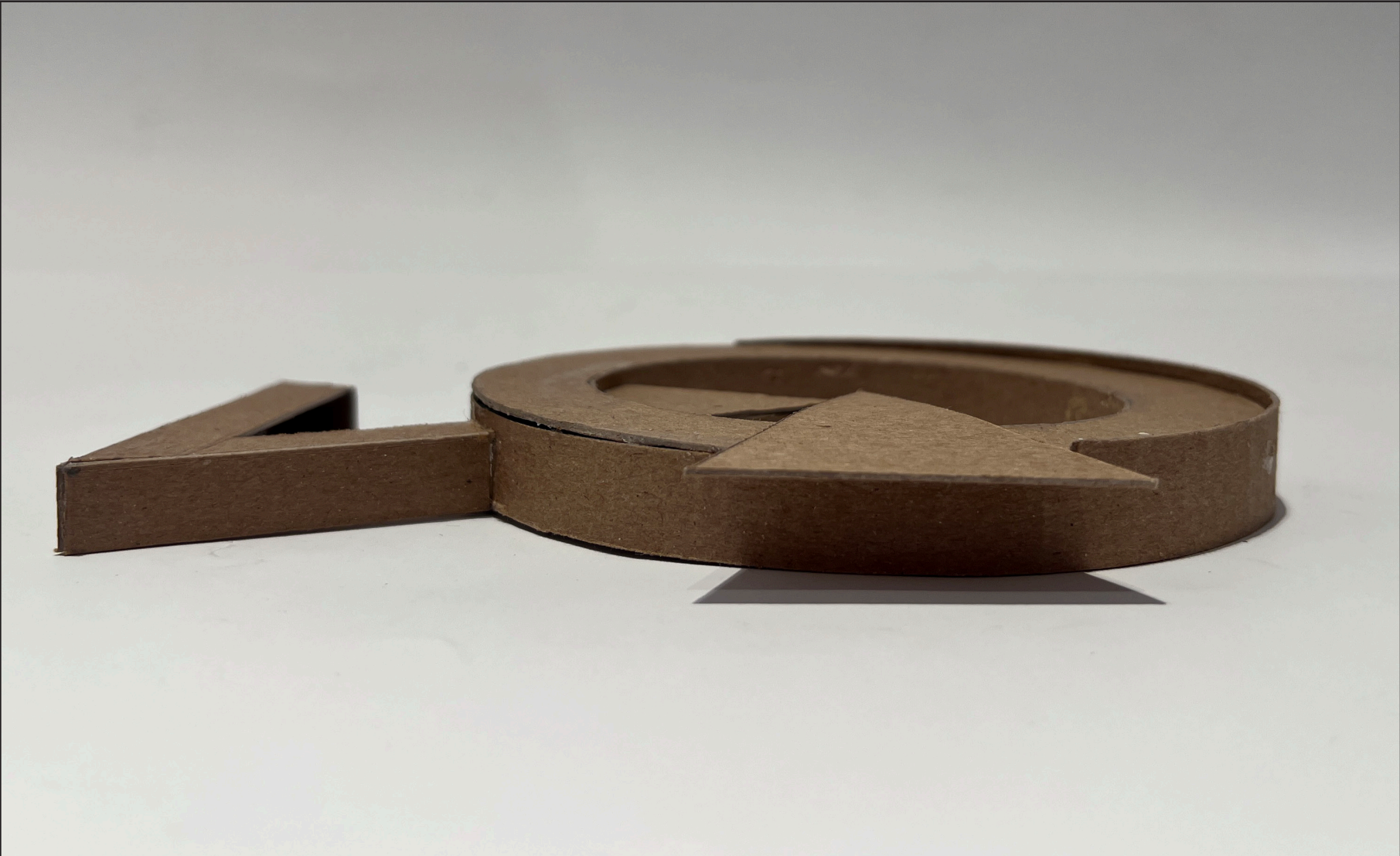
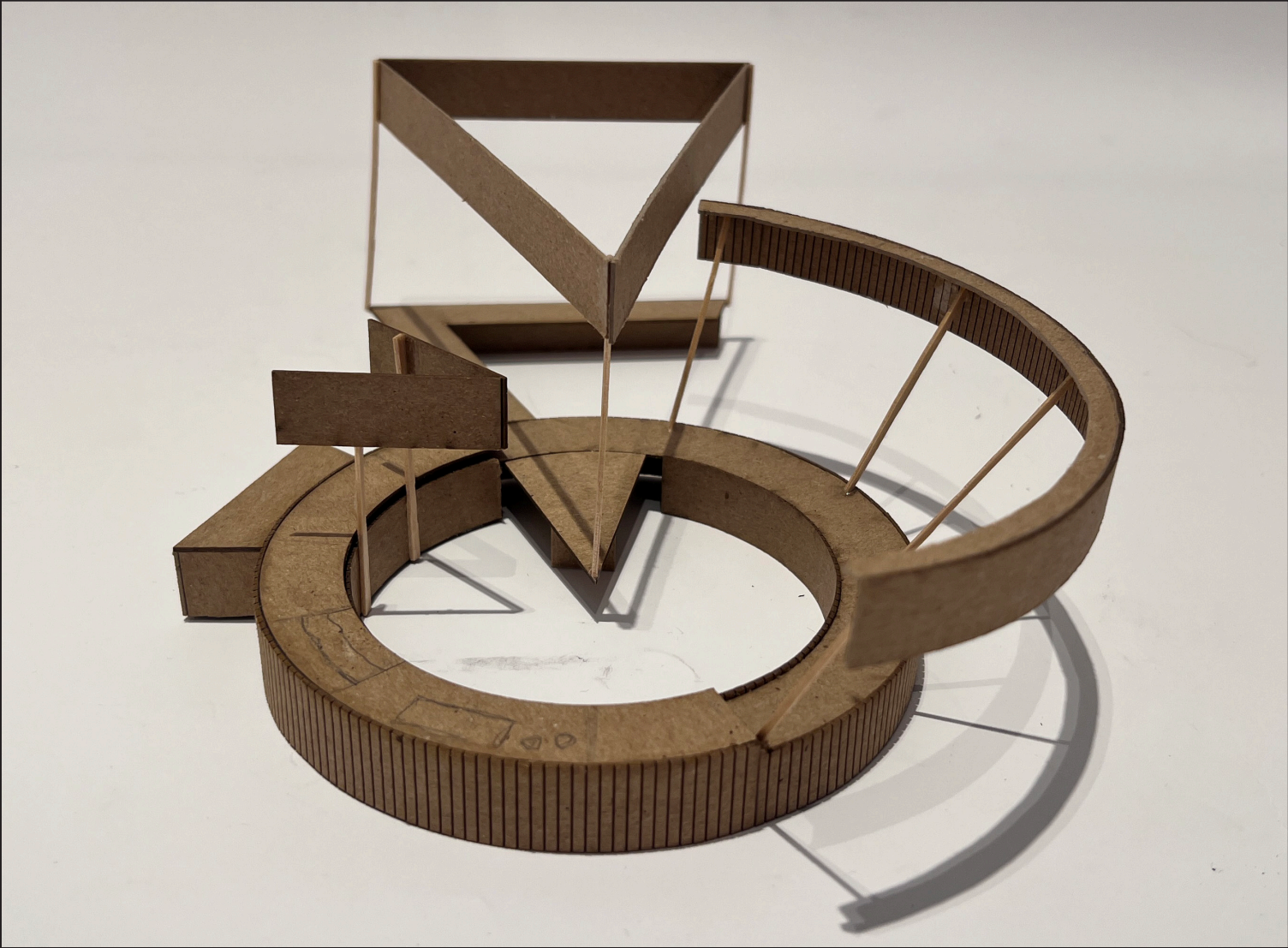
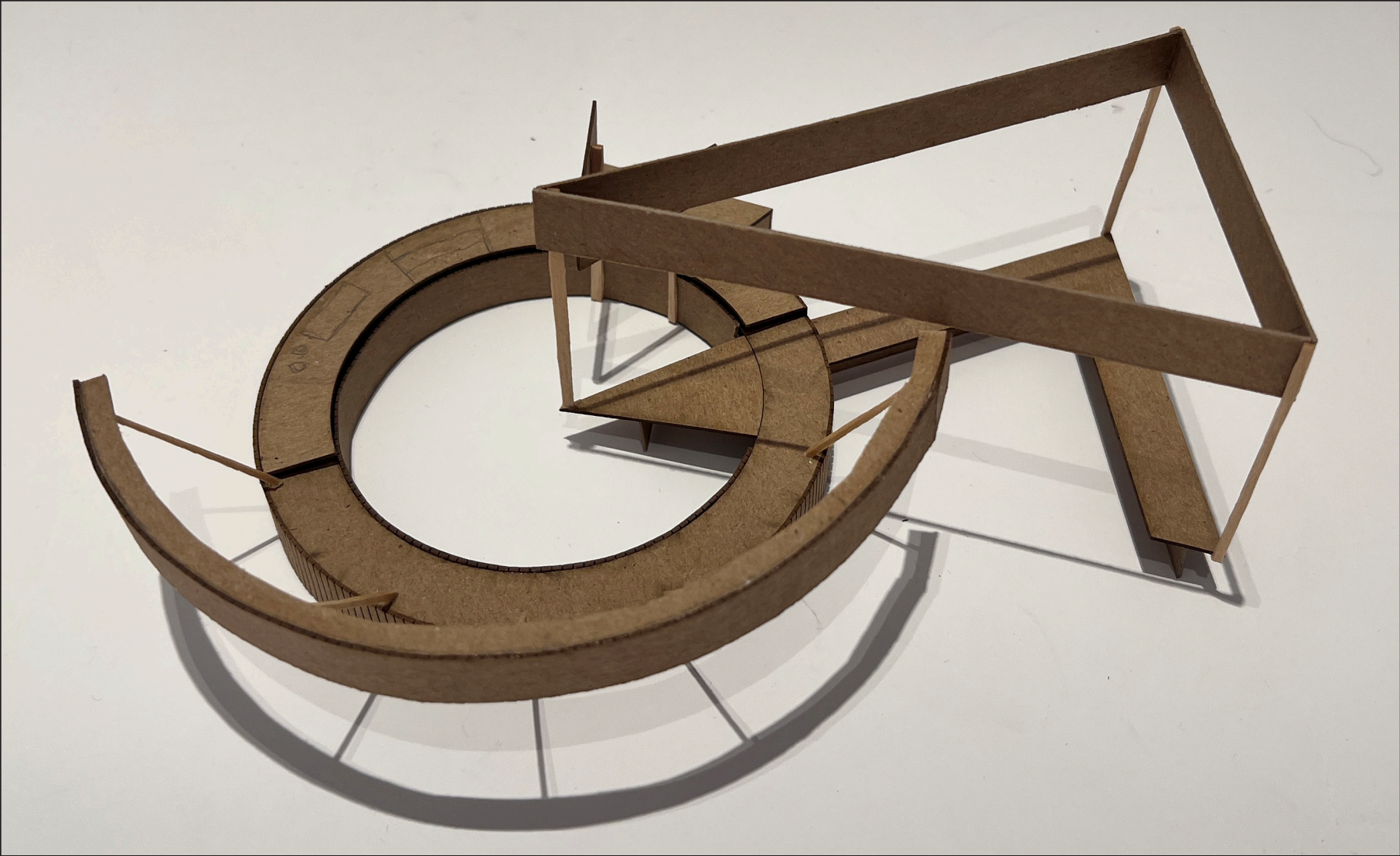

PROCESS CONCEPT MODELS

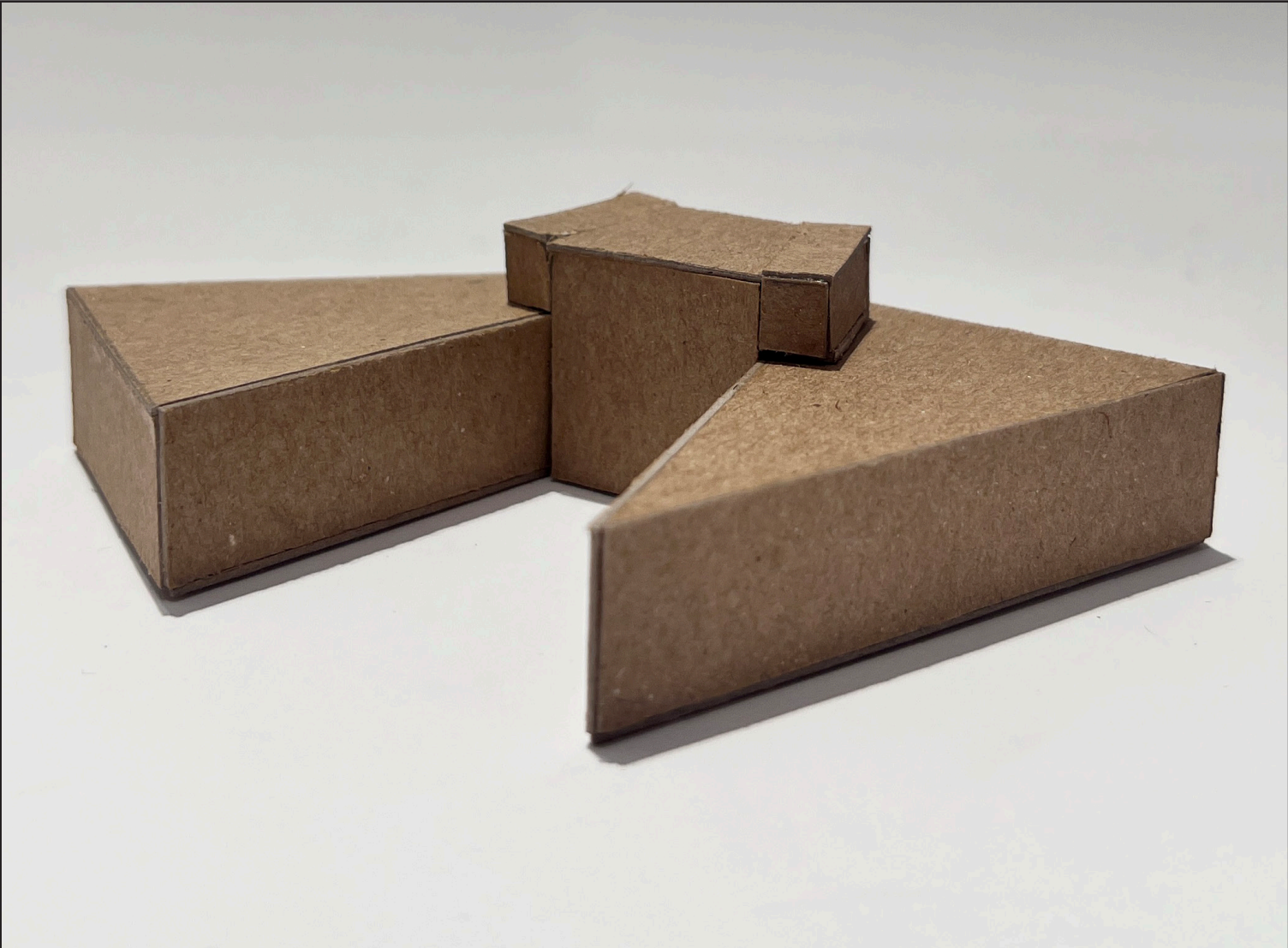
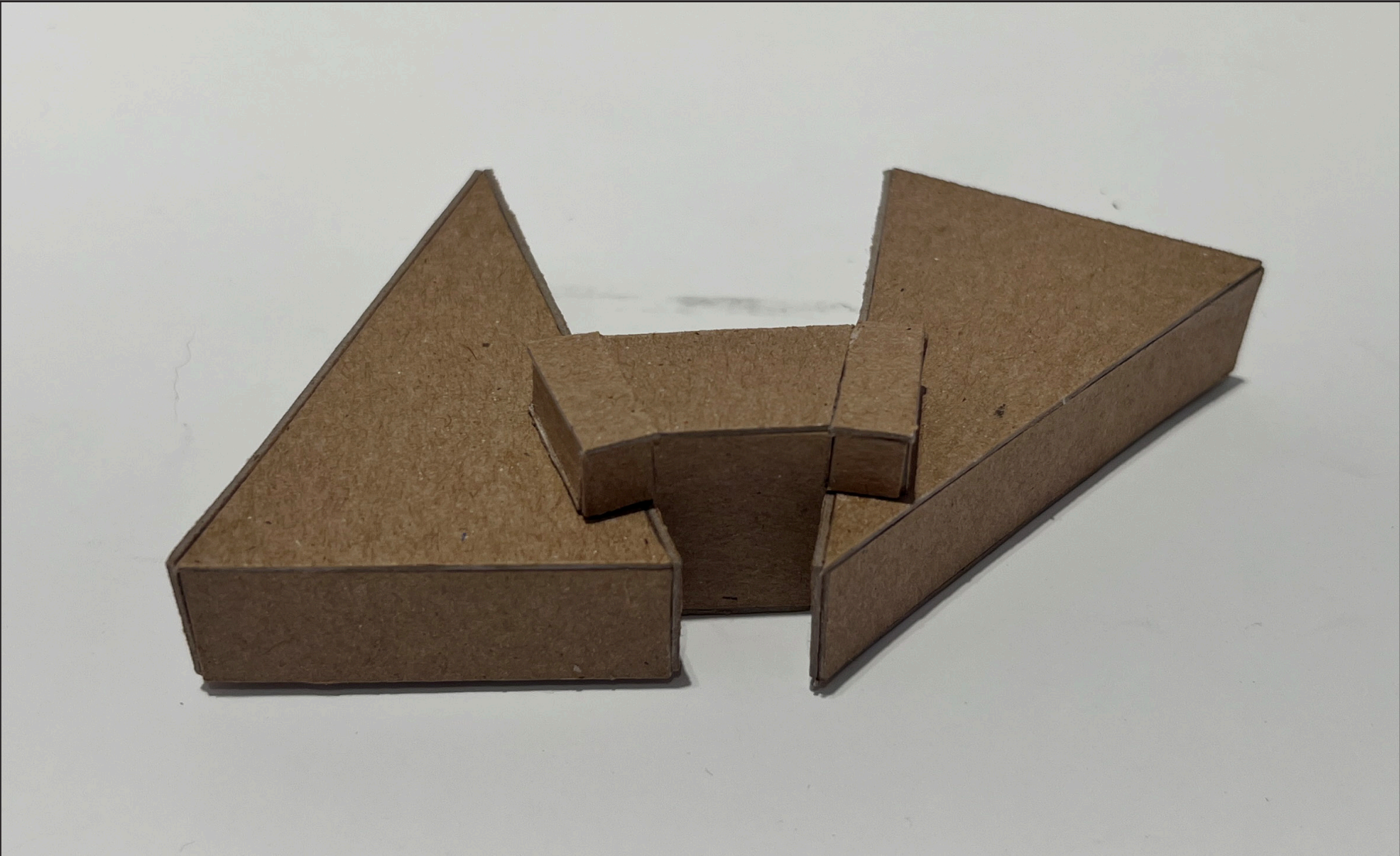
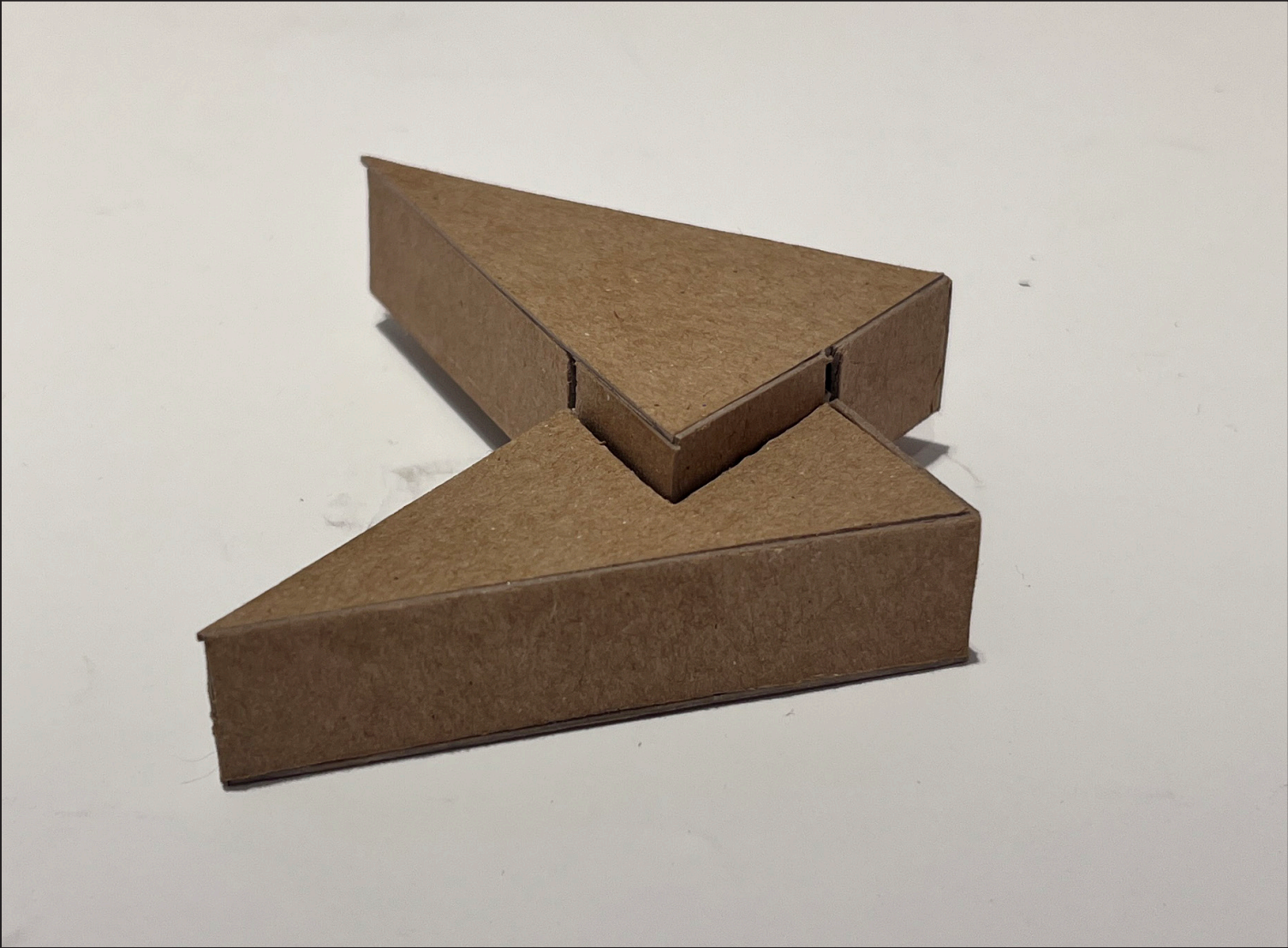

# FINAL PLAN ELEVATION PROCESS SKECTHES

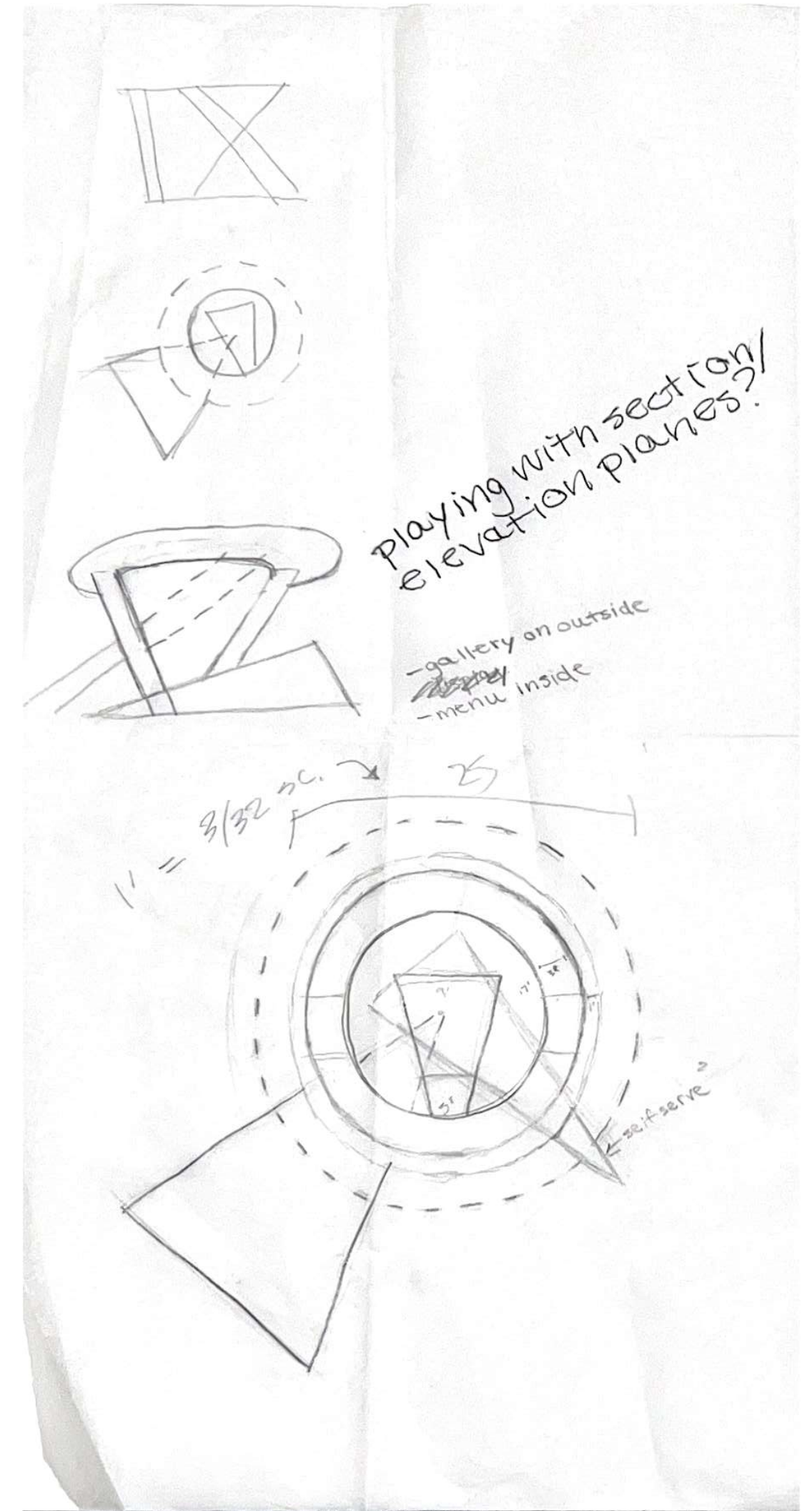
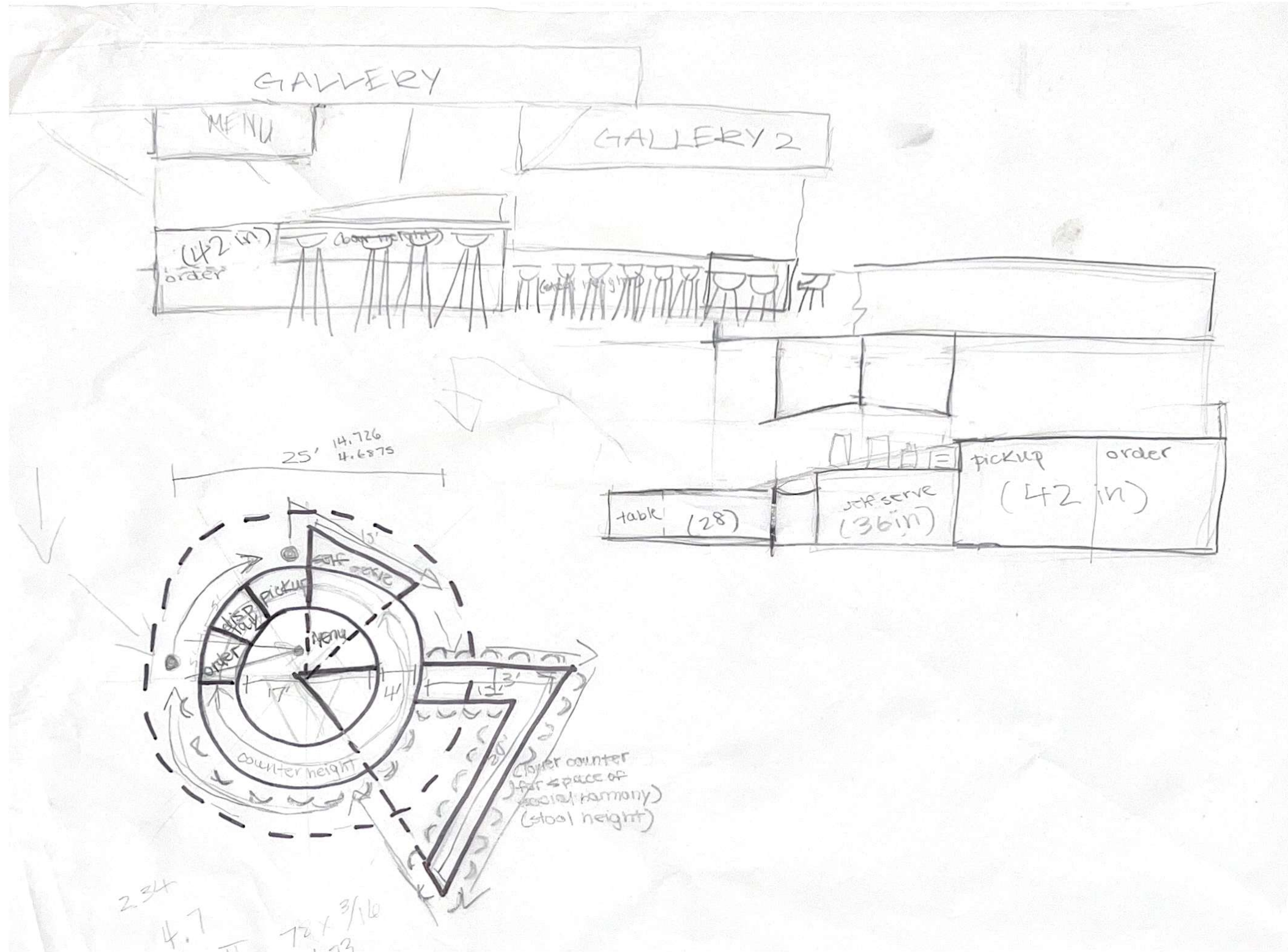



# CONCEPT MODEL IDEATION PROCESS SKETCHES

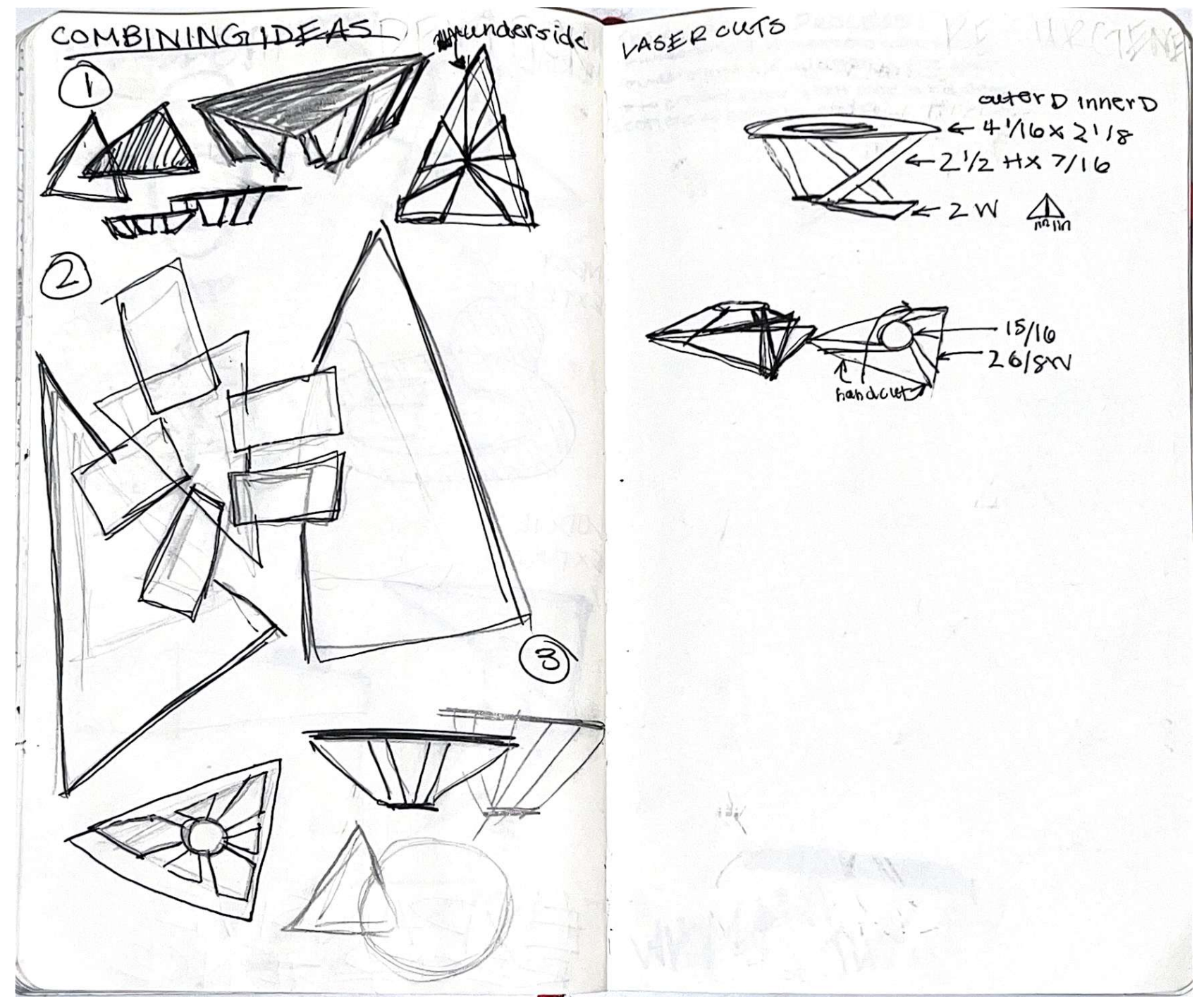
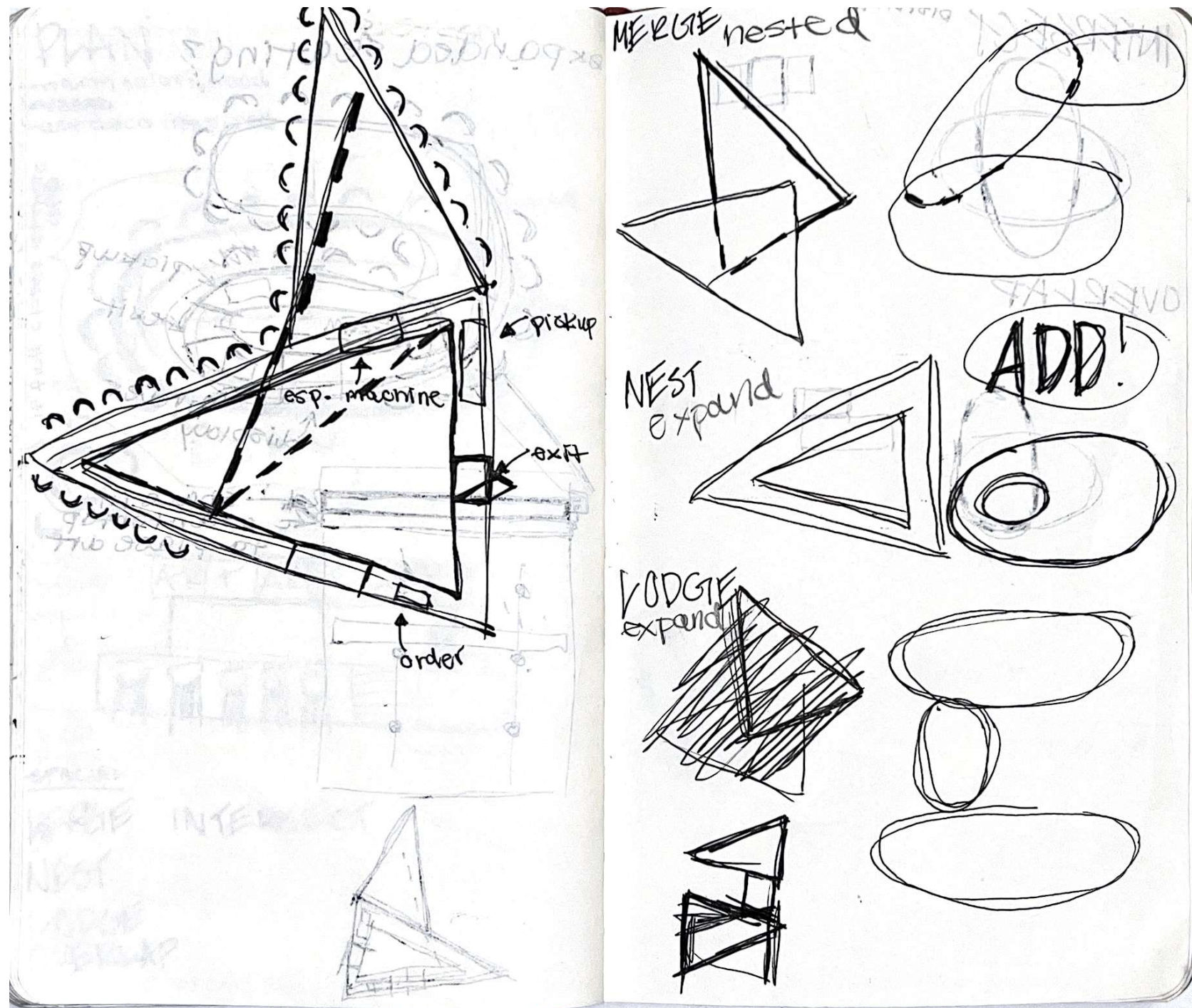

# CONCEPT ETHOS IDEATION

- hyperallergic

"members of the schools community are still adjusting to the culture clash between the corcoran and GW, worried about curricular changes and what they mean for the future and mourning the loss of a unique community."

"cultural disconnect"

"GW has no experience with fine arts"

"corcoran community's unwavering devotion to the pursuit of the arts as fulfilling in and of itself."

"tight knit community... being in the same building has a tangible community-creating effect."

- hub for the art scene in DC

- corcoran was the 1st public art museum in DC

- wanted to be american louvre

- dedicated to art

- exhibited radical and controversial shows like robert mapplethorpe's "perfect moment"

PROPOSAL

- dupont coffee collective

- employee owned (warm and welcoming space)

- donates to the community and non profits

- target audience is community members and who want to build

- CONCEPT

- resurgence of corcoran's history, its bustling community of artists filling the building with art

- using artists work

- build a community (stranger)

- have events

- be open and inviting, no high shelves or open shelves

- something playful and artistic, something that could start a conversation and is integrated in the community

- maybe interchangeable areas around the kiosk for people's art from corcoran

REALISTIC

- orders in the right of kiosk and pickup on the left

- locking cabinets to close down

- central kiosk, like something that brings people together

- merchandise near register in small display

- hand held menus to keep an open plan

- bar seating

- possibly upper cabinets to have central art

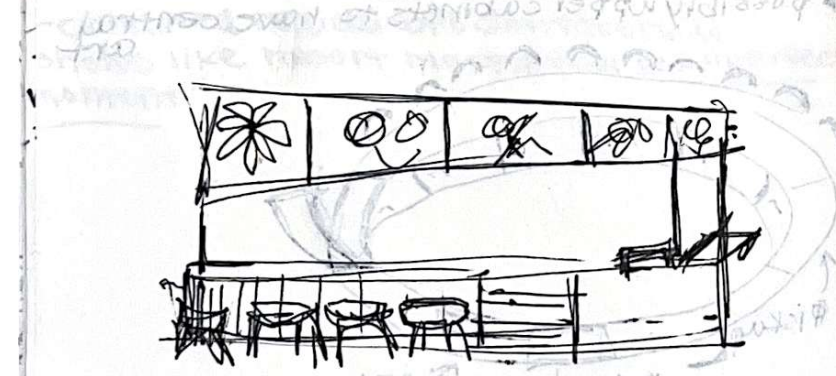
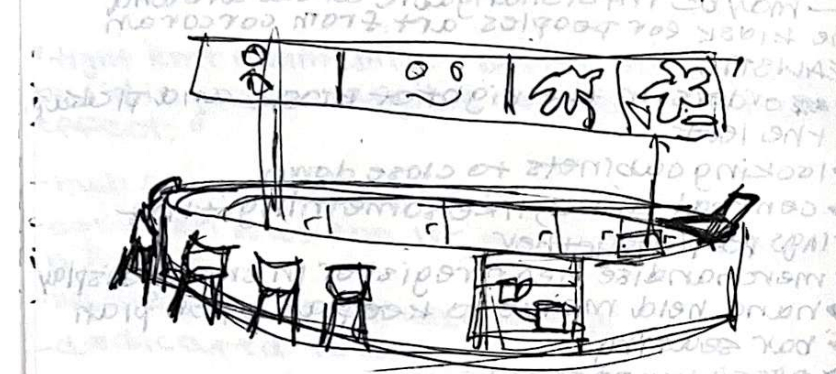
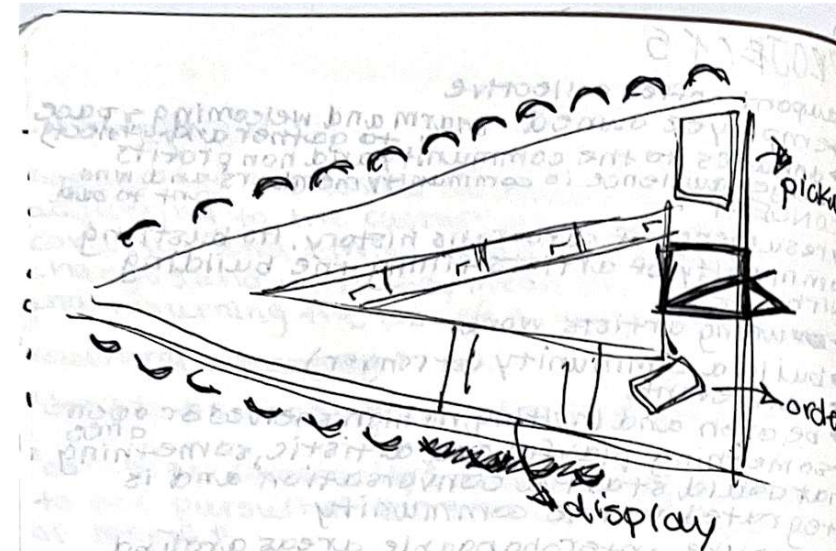
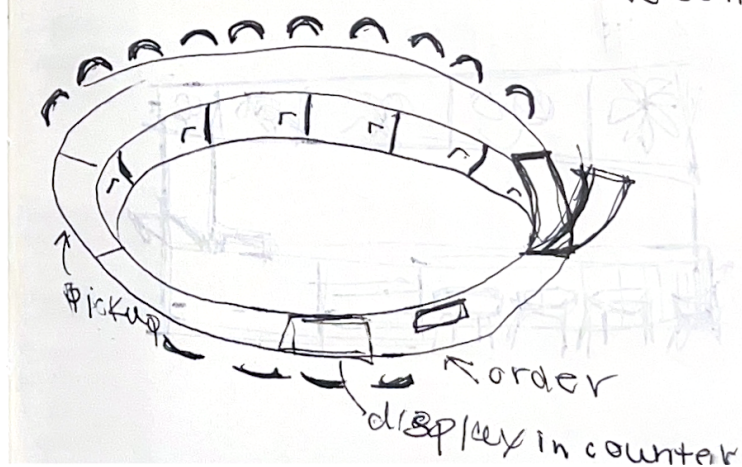

"workers from... firehook bakery recently took collective ownership of their former workplace, remodeling it and reopening under the name dupont coffee collective."

"honor art deco charm of the building while creating a space that feels warm, inviting, and reflective of our community."

"softer paint tones to create light and welcoming atmosphere."

- la marzocco linea espresso machine

- mahlkönig grinders

- coffee blends from swing 5 coffee roasters

"firehooks founder and investors felt it was important to transition ownership of the flagship location to employees."

dedication to art  
 - resurgence - renewal of past rising again into life, activity, or feeling deeply for something and dedication to someone

- fellowship - a group of people that share interests and passion a friendly relationship marked by ready communication and mutual understanding

- devotion - adherence to something to which one is bound by pledge or duty - something with deep meaning to oneself

fellowship  
 communion  
 collaborative-  
 synergic-  
 passion-  
 amity-  
 collective-  
 revival-  
 lead to be a guide into new horizons